

DRILL CHUCKS



INDUSTRIAL SELF TIGHTEN INDUSTRIAL CHUCKS FOR COLUMN OR CNC DRILLING MACHINE

<0,05

Ref. DC1

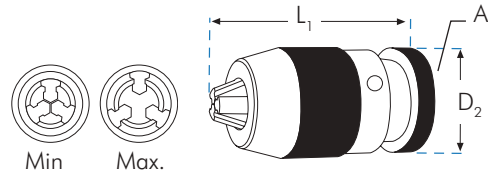
HIGH PRECISION

						DC1
	PRECISION mm	Min.-Max. mm	A	D2 mm	L1 mm	€
DC1-10-B12	<0,05	1-10	B12	42	90	146,78
DC1-13-B16	<0,05	1-13	B16	48	104	157,04
DC1-16-B16	<0,05	1-16	B16	53	119	167,23
DC1-16-B18	<0,05	1-16	B18	53	119	167,23
DC1-20-B22	<0,05	5-20	B22	58	130	192,42

<0,12

Ref. DC2

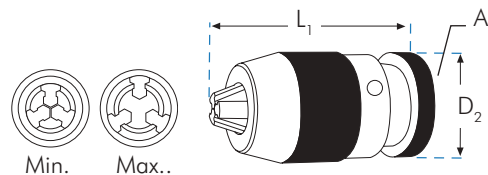
INDUSTRIAL

						DC2
	PRECISION mm	Min.-Max. mm	A	D2 mm	L1 mm	€
DC2-13-1/2	<0,12	1-13	1/2-20 UNF	48	104	115,92
DC2-13-B16	<0,12	1-13	B16	48	104	115,92
DC2-16-B16	<0,12	1-16	B16	53	119	141,88
DC2-16-B18	<0,12	1-16	B18	53	119	141,88
DC2-20-B22	<0,12	5-20	B22	58	130	153,94

<0,20

Ref. DC3

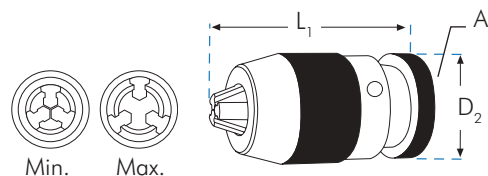
**INDUSTRIAL
LIGHT-WEIGHT**

						DC3
	PRECISION mm	Min.-Max. mm	A	D2 mm	L1 mm	€
DC3-10-3/8	<0,20	1-10	3/8-24 UNF	34	75	71,04
DC3-10-1/2	<0,20	1-10	1/2-20 UNF	34	75	71,04
DC3-13-B16	<0,20	1-13	B16	43	94	76,45
DC3-13-3/8	<0,20	1-13	3/8-24 UNF	43	94	76,45
DC3-13-1/2	<0,20	1-13	1/2-20 UNF	43	94	76,45
DC3-16-B16	<0,20	1-16	B16	48	119	118,66
DC3-16-B18	<0,20	1-16	B18	48	119	118,66
DC3-16-1/2	<0,20	3-16	1/2-20 UNF	48	105	118,66
DC3-16-5/8	<0,20	3-16	5/8-18 UNF	48	105	118,66

INDUSTRIAL TAPER SHANK SELF TIGHTEN INDUSTRIAL CHUCKS FOR COLUMN OR CNC DRILLING MACHINE

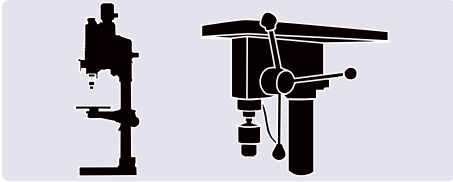

<0,05 Ref. DC10 **HIGH PRECISION**

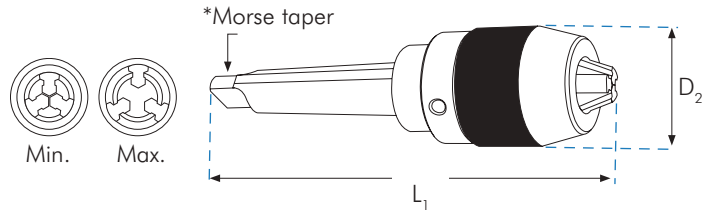

						DC10
	PRECISION mm	Min.-Max. mm	MT*	D2 mm	L1 mm	€
DC10-13-CM2	<0,05	1-13	CM2	51	174	243,70
DC10-13-CM3	<0,05	1-13	CM3	51	192	246,66
DC10-13-CM4	<0,05	1-13	CM4	51	218	249,06
DC10-16-CM3	<0,05	1-16	CM3	56	207	252,20
DC10-16-CM4	<0,05	1-16	CM4	56	232	256,77

<0,12 Ref. DC11 **INDUSTRIAL**

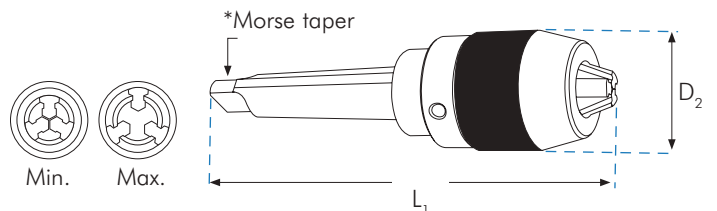

						DC11
	PRECISION mm	Min.-Max. mm	MT*	D2 mm	L1 mm	€
DC11-13-CM2	<0,12	1-13	CM2	51	174	148,94
DC11-13-CM3	<0,12	1-13	CM3	51	192	148,94
DC11-13-CM4	<0,12	1-13	CM4	51	218	148,94
DC11-16-CM3	<0,12	1-16	CM3	56	207	174,63
DC11-16-CM4	<0,12	1-16	CM4	56	232	174,63

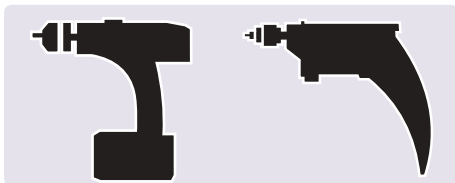
PROFESSIONAL AUTO-LOCK DRILL CHUCKS

<950W

Ref. DC4



- Auto-lock
- Plastic sleeve.
- Rotary and hammer mode drilling.



Min. Max.

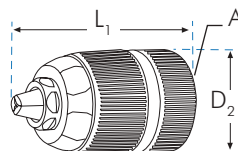

						DC4
	W	Min.-Max. mm	A	D2 mm	L1 mm	€
DC4-10-3/8	<950	1-10	3/8-24 UNF	41	65	42,73
DC4-10-1/2	<950	1-10	1/2-20 UNF	41	65	42,73
DC4-13-3/8	<950	2-13	3/8-24 UNF	43	75	59,08
DC4-13-3/8-SDS	<950	2-13	3/8-24 UNF	43	75	68,16
DC4-13-1/2	<950	2-13	1/2-20 UNF	43	75	59,08
DC4-13-1/2-SDS	<950	2-13	1/2-20 UNF	43	75	68,16

Ref. DC4-13-1/2-SDS

<1050W

Ref. DC5



- Auto-lock
- Metal sleeve
- High power
- Special jaws
- Rotary and hammer mode drilling.



Min. Max.

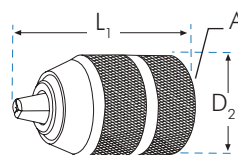

						DC5
	W	Min.-Max. mm	A	D2 mm	L1 mm	€
DC5-10-3/8	<1050	1-10	3/8-24 UNF	41	64	43,47
DC5-13-3/8	<1050	2-13	3/8-24 UNF	43	75	62,34
DC5-13-1/2	<1050	2-13	1/2-20 UNF	43	75	62,34
DC5-13-SDS	<1050	2-13	1/2-20 UNF	43	75	77,16

Ref. DC5-13-SDS

PROFESSIONAL KEY CHUCKS

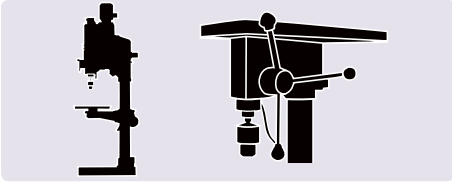

Ref. DC6

- Rotary and hammer mode drilling.
- Key included.

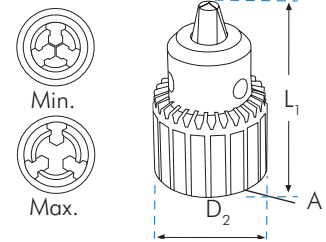

	Min.-Max. mm	A	D2 mm	L1 mm	DC6 €
DC6-06-B10	0,6-6	B10	31	50	41,83
DC6-06-3/8	0,6-6	3/8-24 UNF	31	50	41,83
DC6-10-B12	1-10	B12	37	60	32,76
DC6-10-3/8	1-10	3/8-24 UNF	37	60	32,76
DC6-10-1/2	1-10	1/2-20 UNF	37	60	32,76
DC6-13-B12	1-13	B12	46	78	42,84
DC6-13-B16	1-13	B16	46	78	42,84
DC6-13-3/8	1-13	3/8-24 UNF	46	78	42,84
DC6-13-1/2	1-13	1/2-20 UNF	46	78	42,84
DC6-16-B16	1-16	B16	57	95	47,88
DC6-16-B18	1-16	B18	57	95	47,88
DC6-16-1/2	1-16	1/2-20 UNF	57	95	47,88
DC6-16-5/8	1-16	5/8-18 UNF	57	95	50,39
DC6-19-B22	1-19	B22	68	115	65,52



Ref. DC7

- Rotary and hammer mode drilling.
- Key included.

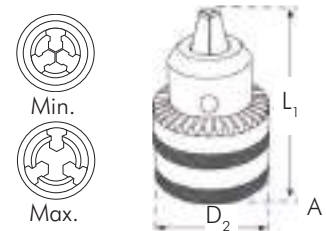

	Min.-Max. mm	A	D2 mm	L1 mm	DC7 €
DC7-06-B10	0,6-6	B10	30	50	19,09
DC7-06-3/8	0,6-6	3/8-24 UNF	30	50	19,09
DC7-10-3/8	1,5-10	3/8-24 UNF	33	59	18,67
DC7-10-1/2	1,5-10	1/2-20 UNF	33	59	18,67
DC7-13-B12	1,5-13	B12	42	70	22,17
DC7-13-B16	1,5-13	B16	42	70	22,17
DC7-13-3/8	1,5-13	3/8-24 UNF	42	70	22,17
DC7-13-1/2	1,5-13	1/2-20 UNF	42	70	22,17
DC7-13-SDS	1,5-13	1/2-20 UNF	42	70	23,33
DC7-16-B16	3-16	B16	51	87	28,00
DC7-16-1/2	3-16	1/2-20 UNF	51	87	28,00
DC7-16-5/8	3-16	5/8-18 UNF	51	87	28,00

Ref. DC7-13-SDS

• For spare keys see next page

MACHINE AND MANUAL MINI DRILL CHUCKS
MANUAL MINI-DRILL CHUCK

P27

 Includes reversible collet:
 - From 0 to 3,0 mm diameter

8,98 €
MACHINE MINI-DRILL CHUCK

P28

 Includes 3 jaws:
 - From 0 to 1 mm - From 1 to 2 mm
 - From 0,5 to 1,5 mm

13,45 €
HEX. SHANK MINI DRILL CHUCK

P29

 - 1/4 Hex. Shank
 - From 0,6 to 6,0 mm

15,26 €
ACCESSORIES FOR DRILLS & DRILL CHUCKS
DRILL CHUCK KEYS

	Min.-Max. mm	Ø mm	DC
DC-10	1 - 10	6	3,42
DC-13	1 - 13	6	4,06
DC-16	1 - 16	8	5,05
DC-20	5 - 20	9	8,96

SDS-PLUS ADAPTER

	Thread	DC
DC -3/8	3/8 - 24 UNF	20,40
DC -1/2	1/2 - 20 UNF	20,40

1/4" Hex. ADAPTER

	Shank	Thread	DC-01
DC-01	1/4" Hex.	3/8 - 24 UNF	11,81

SDS PLUS ADAPTER FOR 1/2X20 UNF DRILL CHUCKS

	Thread		DC-02
DC-02	1/2x20UNF	SDS plus	49,51

ACCESSORIES

REDUCTION SLEEVES

DIN 2185



MORSE TAPER		L ₁ mm	CR		MORSE TAPER		L ₁ mm	CR	
EXT.	INT.		€		EXT.	INT.		€	
1	0	80	19,21		5	1	156	63,53	
2	1	92	19,23		5	2	156	57,98	
3	1	99	25,88		5	3	156	57,98	
3	2	112	26,38		5	4	171	64,89	
4	1	124	36,91		6	3	218	112,63	
4	2	124	34,68		6	4	218	127,80	
4	3	140	34,68		6	5	218	127,80	

INCREASE SOCKET

DIN 2187



MORSE TAPER		L ₁ mm	CA	
EXT.	INT.		€	
1	2	160	37,38	
2	3	196	50,82	
3	4	240	85,71	
4	5	300	143,87	
5	6	415	404,31	

EXTENSION REDUCING SLEEVES

DIN 2187



MORSE TAPER		L ₁ mm	CA		MORSE TAPER		L ₁ mm	CA	
EXT.	INT.		€		EXT.	INT.		€	
2	1	160	24,13		5	2	247	112,23	
3	1	175	35,09		5	3	268	98,90	
3	2	194	36,23		5	4	300	111,79	
4	1	200	50,82		6	3	330	246,17	
4	2	215	49,67		6	4	355	246,17	
4	3	240	51,97		6	5	390	247,99	
5	1	232	123,45						

EXTENSION SLEEVES

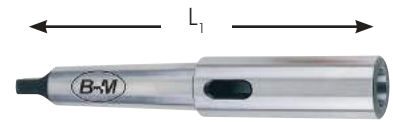

MORSE TAPER		L ₁ mm	CA	
EXT.	INT.		€	
1	1	145	24,13	
2	2	175	35,09	
3	3	215	53,15	
4	4	265	85,71	
5	5	335	184,96	
6	6	470	424,52	

TAPER DRILL CHUCK ARBOR

DIN 228 * MORSE TAPER **DIN 238** ARBOR

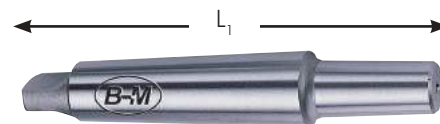

MT*	ARBOR	L ₁ mm	CM €
1	B10	86	10,44
1	B12	89	7,85
1	B16	99	7,85
1	B18	107	7,85
2	B10	105	12,48
2	B12	106	9,53
2	B16	112	9,53
2	B18	119	9,53
2	B22	130	16,40
3	B12	127	15,92
3	B16	134	11,61
3	B18	140	11,61

MT*	ARBOR	L ₁ mm	CM €
3	B22	147	19,55
3	B24	157	25,17
4	B16	158	17,46
4	B18	166	17,93
4	B22	176	32,24
4	B24	186	32,61
5	B16	193	70,83
5	B18	200	70,83
5	B22	208	65,97
5	B24	221	71,66
6	B22	240	134,75

DRILLS AND DRILL CHUCKS ACCESSORIES
DRILL DRIFTS
**DIN
317**



			CE
N°	USEFULL FOR MT	L ₁ mm	€
0	0	90	10,71
1	1 / 2	140	12,66
3	3	190	16,71
4	4	225	22,73
5	5 / 6	265	36,91

TAPER DRILL CHUCK THREADED ARBOR
**DIN
2185**

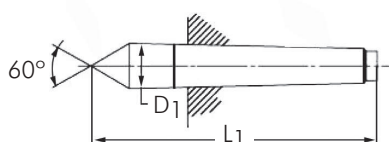
			CMR				CMR
	MORSE TAPER	A	€		MORSE TAPER	A	€
CMR1-3/8	1	3/8-24h	15,80	CMR2-5/8	2	5/8-18h	15,80
CMR1-1/2	1	1/2-20h	15,80	CMR3-3/8	3	3/8-24h	21,39
CMR2-3/8	2	3/8-24h	15,80	CMR3-1/2	3	1/2-20h	21,39
CMR2-1/2	2	1/2-20h	15,80	CMR3-5/8	3	5/8-18h	21,39

ACCESSORIES
LATHE CENTER

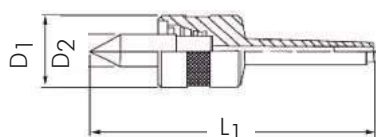
				CPC	CPC..MD	
	D ₁ mm	L ₁ mm	MT* INT.	€	SOLID CARBIDE	€
CPCM1	12	80	1	11,60		
CPCM2	18	100	2	15,43	CPCM2-MD	44,35
CPCM3	24	125	3	23,98	CPCM3-MD	60,53
CPCM4	31	160	4	37,45	CPCM4-MD	73,82
CPCM5	44	200	5	52,92	CPCM5-MD	125,50
CPCM6	63	270	6	204,03		

LIVE CENTER

					PGC
	D ₁ mm	D ₂ mm	L ₁ mm	MT*	€
PGCM1	34	18	120	1	111,10
PGCM2	50	21	148	2	123,91
PGCM3	60	24	185	3	166,58
PGCM4	63	28	220	4	197,43
PGCM5	75	36	260	5	285,35

TAP HOLDERS

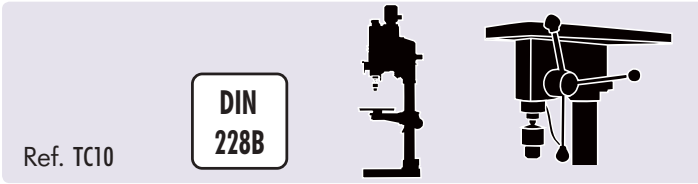

Ref. TC10

DIN 228B

- With longitudinal compensation in compression and traction
- Taper Shank

						TC10
	D1 mm	D3 mm	L1 mm	L2 mm	MORSE TAPER	€
TC10-19-CM2	36	19	122	47	2	251,92
TC10-19-CM3	36	19	141	47	3	321,86
TC10-31-CM3	53	31	165	71	3	414,17
TC10-31-CM4	53	31	189	72	4	461,50
TC10-48-CM4	78	48	222	105	4	698,17
TC10-48-CM5	78	48	255	106	5	745,50

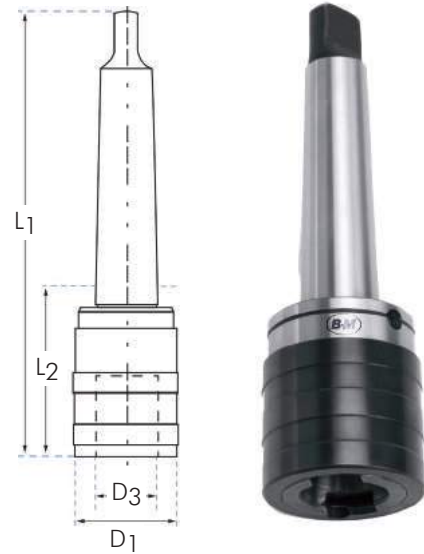

TAP HOLDER WITHOUT CLUTCH

TAP HOLDER WITH CLUTCH

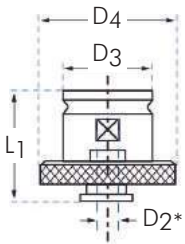

					TC15
	D2 mm	D3 mm	L1 mm	D4 mm	€
TC15-19-035	3,5	19	28	30	33,73
TC15-19-040	4,0	19	28	30	33,73
TC15-19-045	4,5	19	28	30	33,73
TC15-19-060	6,0	19	28	30	33,73
TC15-19-070	7,0	19	28	30	33,73
TC15-19-080	8,0	19	28	30	33,73
TC15-19-090	9,0	19	28	30	33,73
TC15-19-100	10,0	19	28	30	33,73
TC15-31-070	7,0	31	46	48	47,36
TC15-31-080	8,0	31	46	48	47,36
TC15-31-090	9,0	31	46	48	47,36
TC15-31-100	10,0	31	46	48	47,36
TC15-31-110	11,0	31	46	48	47,36
TC15-31-120	12,0	31	46	48	47,36
TC15-31-140	14,0	31	46	48	47,36
TC15-31-160	16,0	31	46	48	47,36
TC15-48-110	11,0	48	69	70	125,48
TC15-48-120	12,0	48	69	70	125,48
TC15-48-140	14,0	48	69	70	125,48
TC15-48-160	16,0	48	69	70	125,48
TC15-48-180	18,0	48	69	70	125,48
TC15-48-200	20,0	48	69	70	125,48
TC15-48-220	22,0	48	69	70	125,48
TC15-48-250	25,0	48	69	70	125,48
TC15-48-280	28,0	48	69	70	125,48

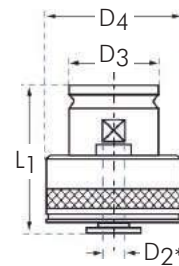

					TC16
	D2 mm	D3 mm	L1 mm	D4 mm	€
TC16-19-035	3,5	19	46	32	80,96
TC16-19-040	4,0	19	46	32	80,96
TC16-19-045	4,5	19	46	32	80,96
TC16-19-060	6,0	19	46	32	80,96
TC16-19-070	7,0	19	46	32	80,96
TC16-19-080	8,0	19	46	32	80,96
TC16-19-090	9,0	19	46	32	80,96
TC16-19-100	10,0	19	46	32	80,96
TC16-31-070	7,0	31	69	50	102,54
TC16-31-080	8,0	31	69	50	102,54
TC16-31-090	9,0	31	69	50	102,54
TC16-31-100	10,0	31	69	50	102,54
TC16-31-110	11,0	31	69	50	102,54
TC16-31-120	12,0	31	69	50	102,54
TC16-31-140	14,0	31	69	50	102,54
TC16-31-160	16,0	31	69	50	102,54
TC16-48-110	11,0	48	100	70	227,03
TC16-48-120	12,0	48	100	70	227,03
TC16-48-140	14,0	48	100	70	227,03
TC16-48-160	16,0	48	100	70	227,03
TC16-48-180	18,0	48	100	70	227,03
TC16-48-200	20,0	48	100	70	227,03
TC16-48-220	22,0	48	100	70	227,03
TC16-48-250	25,0	48	100	70	227,03
TC16-48-280	28,0	48	100	70	227,03

* D2: Ø of the shank of the tap

* To get information about the Ø of the shank of the tap please consult pag 116.

TAPS SUITABLES FOR TAP HOLDER WITH/WITHOUT CLUTCH

D2 mm.								
3,5	4	4,5	6	7	8	9	10	11
M3x0,50R	M3,5x0,60R	M4x0,50R	M4,5x0,50R	M9x1,00D	M8x1,25R	M9x1,25R	M10x1,50R	M13x0,75D
M3x0,60R	M3,5x0,75R	M4x0,70R	M4,5x0,75R	M9x1,25D	M11x0,75D	M12x0,75D		M13x1,00D
M5x0,50D		M4x0,75R	M5x0,50R	M10x0,50D	M11x1,00D	M12x1,00D		M13x1,25D
M5x0,75D		M4x0,80R	M5x0,75R	M10x0,75D	M11x1,25D	M12x1,25D		M13x1,50D
M5x0,80D		M6x0,50D	M5x0,80R	M10x1,00D	M11x1,50D	M12x1,50D		M13x1,75D
M5x0,90D		M6x0,75D	M5x0,90R	M10x1,25D		M12x1,75D		M14x0,75D
		M6x1,00D	M5x1,00R	M10x1,50D				M14x1,00D
			M5,5x0,90R					M14x1,25D
			M6x0,50R					M14x1,50D
			M6x0,75R					M14x2,00D
			M6x1,00R					
			M6x1,25R					
			M8x0,50D					
			M8x0,75D					
			M8x1,00D					
			M8x1,25D					
			M8x1,50D					

D2 mm.							
12	14	16	18	20	22	25	28
M15x1,00D	M18x1,00D	M20x1,00D	M22x1,00D	M27x1,00D	M30x1,00D	M33x1,00D	M34x1,50D
M15x1,25D	M18x1,25D	M20x1,25D	M22x1,25D	M27x1,50D	M30x1,50D	M33x1,50D	M34x2,00D
M15x1,50D	M18x1,50D	M20x1,50D	M22x1,50D	M27x2,00D	M30x2,00D	M33x2,00D	M35x1,50D
M15x2,00D	M18x2,00D	M20x2,00D	M22x2,00D	M27x3,00D	M30x3,00D	M33x3,50D	M35x2,00D
M16x1,00D	M18x2,50D	M20x2,50D	M22x2,50D	M28x1,00D	M30x3,50D		M36x1,50D
M16x1,25D	M19x1,00D	M21x1,00D	M23x1,00D	M28x1,50D	M32x1,00D		M36x2,00D
M16x1,50D	M19x1,25D	M21x1,25D	M23x1,50D	M28x2,00D	M32x1,50D		M36x3,00D
M16x2,00D	M19x1,50D	M21x1,50D	M24x1,00D		M32x2,00D		M36x4,00D
M17x1,00D	M19x2,00D		M24x1,25D				M38x1,50D
M17x1,25D			M24x1,50D				M38x2,00D
M17x1,50D			M24x2,00D				
			M24x3,00D				
			M25x1,00D				
			M25x1,25D				
			M25x1,50D				
			M25x2,00D				
			M26x1,00D				
			M26x1,50D				
			M26x2,00D				

* D2: Ø of the shank of the tap

* Chart is for taps DIN 371/374/DIN376

* R: Reinforced

* D: Straight/Reduced

PRECISION COLLET

Ref. ER8

TYPE
ER

DIN
6499-B

Collets to be used in cutting tools with plain straight shank.

D2: 8,5
L1: 13,5

α : 8°
 β : 30°

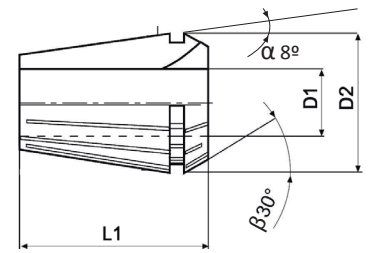

ER8					
	EXC 0,01 INDUSTRIAL		EXC 0,005 HIGH PRECISION		
	Capacity D1	€		Capacity D1	€
ER8-1	0,5-1,0	42,80	ER8-1MICRO	0,5-1,0	-
ER8-1,5	1,0-1,5	42,80	ER8-1,5MICRO	1,0-1,5	-
ER8-2	1,5-2,0	36,68	ER8-2MICRO	1,5-2,0	-
ER8-2,5	2,0-2,5	36,68	ER8-2,5MICRO	2,0-2,5	-
ER8-3	2,5-3,0	32,20	ER8-3MICRO	2,5-3,0	-
ER8-3,5	3,0-3,5	32,20	ER8-3,5MICRO	3,0-3,5	-
ER8-4	3,5-4,0	32,20	ER8-4MICRO	3,5-4,0	-
ER8-4,5	4,0-4,5	32,20	ER8-4,5MICRO	4,0-4,5	-
ER8-5	4,5-5,0	32,20	ER8-5MICRO	4,5-5,0	-

Ref. ER11

TYPE
ER

DIN
6499-B

D2: 11,5
L1: 18

α : 8°
 β : 30°

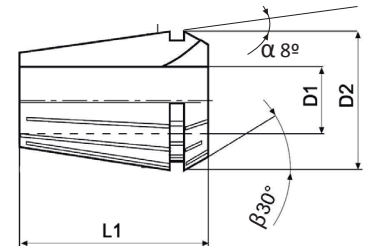

ER11					
	EXC 0,01 INDUSTRIAL		EXC 0,005 HIGH PRECISION		
	Capacity D1	€		Capacity D1	€
ER11-1	0,5-1,0	40,76	ER11-1MICRO	0,5-1,0	-
ER11-1,5	1,0-1,5	40,76	ER11-1,5MICRO	1,0-1,5	-
ER11-2	1,5-2,0	34,94	ER11-2MICRO	1,5-2,0	-
ER11-2,5	2,0-2,5	34,94	ER11-2,5MICRO	2,0-2,5	-
ER11-3	2,5-3,0	30,67	ER11-3MICRO	2,5-3,0	-
ER11-3,5	3,0-3,5	30,67	ER11-3,5MICRO	3,0-3,5	43,91
ER11-4	3,5-4,0	30,67	ER11-4MICRO	3,5-4,0	43,91
ER11-4,5	4,0-4,5	30,67	ER11-4,5MICRO	4,0-4,5	43,91
ER11-5	4,5-5,0	30,67	ER11-5MICRO	4,5-5,0	43,91
ER11-5,5	5,0-5,5	30,67	ER11-5,5MICRO	5,0-5,5	43,91
ER11-6	5,5-6,0	30,67	ER11-6MICRO	5,5-6,0	43,91
ER11-6,5	6,0-6,6	30,67	ER11-6,5MICRO	6,0-6,6	43,91
ER11-7	6,5-7,0	30,67	ER11-7MICRO	6,5-7,0	43,91

PRECISION COLLET

Ref. ER16

TYPE
ER
DIN
6499-B

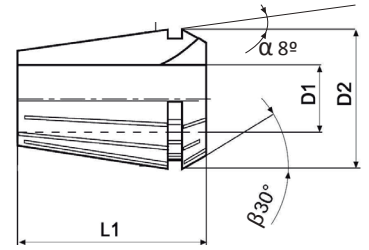
D2: 17 $\alpha: 8^\circ$
L1: 27,5 $\beta: 30^\circ$

ER16

	EXC 0,01 INDUSTRIAL		EXC 0,005 HIGH PRECISION		
	Capacity D1	€	Capacity D1	€	
ER16-1	0,5-1,0	36,52	ER16-1MICRO	0,5-1,0	-
ER16-2	1,0-2,0	32,88	ER16-2MICRO	1,0-2,0	-
ER16-3	2,0-3,0	29,58	ER16-3MICRO	2,0-3,0	-
ER16-4	3,0-4,0	29,58	ER16-4MICRO	3,0-4,0	39,10
ER16-5	4,0-5,0	29,58	ER16-5MICRO	4,0-5,0	39,10
ER16-6	5,0-6,0	29,58	ER16-6MICRO	5,0-6,0	39,10
ER16-7	6,0-7,0	29,58	ER16-7MICRO	6,0-7,0	39,10
ER16-8	7,0-8,0	29,58	ER16-8MICRO	7,0-8,0	39,10
ER16-9	8,0-9,0	29,58	ER16-9MICRO	8,0-9,0	39,10
ER16-10	9,0-10,0	29,58	ER16-10MICRO	9,0-10,0	39,10

Ref. ER25

TYPE
ER
DIN
6499-B

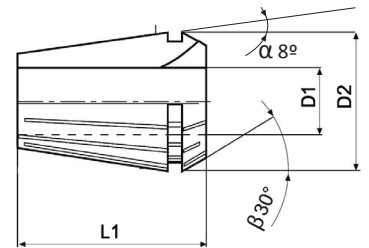
D2: 26 $\alpha: 8^\circ$
L1: 34 $\beta: 30^\circ$

ER25

	EXC 0,01 INDUSTRIAL		EXC 0,005 HIGH PRECISION		
	Capacity D1	€	Capacity D1	€	
ER25-2	1,0-2,0	33,87	ER25-2MICRO	1,0-2,0	-
ER25-3	2,0-3,0	33,87	ER25-3MICRO	2,0-3,0	-
ER25-4	3,0-4,0	33,87	ER25-4MICRO	3,0-4,0	42,11
ER25-5	4,0-5,0	33,87	ER25-5MICRO	4,0-5,0	42,11
ER25-6	5,0-6,0	33,87	ER25-6MICRO	5,0-6,0	42,11
ER25-7	6,0-7,0	33,87	ER25-7MICRO	6,0-7,0	42,11
ER25-8	7,0-8,0	33,87	ER25-8MICRO	7,0-8,0	42,11
ER25-9	8,0-9,0	33,87	ER25-9MICRO	8,0-9,0	42,11
ER25-10	9,0-10,0	33,87	ER25-10MICRO	9,0-10,0	42,11
ER25-11	10,0-11,0	33,87	ER25-11MICRO	10,0-11,0	42,11
ER25-12	11,0-12,0	33,87	ER25-12MICRO	11,0-12,0	42,11
ER25-13	12,0-13,0	33,87	ER25-13MICRO	12,0-13,0	42,11
ER25-14	13,0-14,0	33,87	ER25-14MICRO	13,0-14,0	42,11
ER25-15	14,0-15,0	33,87	ER25-15MICRO	14,0-15,0	42,11
ER25-16	15,0-16,0	33,87	ER25-16MICRO	15,0-16,0	42,11

PRECISION COLLET

Ref. ER32

TYPE
ER

DIN
6499-B

D2: 33 α: 8°
L1: 40 β: 30°

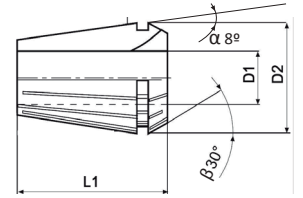

ER32

EXC 0,01 INDUSTRIAL			EXC 0,005 HIGH PRECISION		
	Capacity D1	€		Capacity D1	€
ER32-3	2,0-3,0	32,19	ER32-3MICRO	2,0-3,0	-
ER32-4	3,0-4,0	32,19	ER32-4MICRO	3,0-4,0	43,97
ER32-5	4,0-5,0	32,19	ER32-5MICRO	4,0-5,0	43,97
ER32-6	5,0-6,0	32,19	ER32-6MICRO	5,0-6,0	43,97
ER32-7	6,0-7,0	32,19	ER32-7MICRO	6,0-7,0	43,97
ER32-8	7,0-8,0	32,19	ER32-8MICRO	7,0-8,0	43,97
ER32-9	8,0-9,0	32,19	ER32-9MICRO	8,0-9,0	43,97
ER32-10	9,0-10,0	32,19	ER32-10MICRO	9,0-10,0	43,97
ER32-11	10,0-11,0	32,19	ER32-11MICRO	10,0-11,0	43,97
ER32-12	11,0-12,0	32,19	ER32-12MICRO	11,0-12,0	43,97
ER32-13	12,0-13,0	32,19	ER32-13MICRO	12,0-13,0	43,97
ER32-14	13,0-14,0	32,19	ER32-14MICRO	13,0-14,0	43,97
ER32-15	14,0-15,0	32,19	ER32-15MICRO	14,0-15,0	43,97
ER32-16	15,0-16,0	32,19	ER32-16MICRO	15,0-16,0	43,97
ER32-17	16,0-17,0	32,19	ER32-17MICRO	16,0-17,0	43,97
ER32-18	17,0-18,0	32,19	ER32-18MICRO	17,0-18,0	43,97
ER32-19	18,0-19,0	32,19	ER32-19MICRO	18,0-19,0	43,97
ER32-20	19,0-20,0	32,19	ER32-20MICRO	19,0-20,0	43,97

Ref. ER40

TYPE
ER

DIN
6499-B

D2: 41 α: 8°
L1: 46 β: 30°

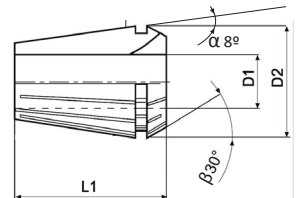

ER40

EXC 0,01 INDUSTRIAL			EXC 0,005 HIGH PRECISION		
	Capacity D1	€		Capacity D1	€
ER40-3	2,0-3,0	40,91	ER40-3MICRO	2,0-3,0	-
ER40-4	3,0-4,0	40,91	ER40-4MICRO	3,0-4,0	52,33
ER40-5	4,0-5,0	40,91	ER40-5MICRO	4,0-5,0	52,33
ER40-6	5,0-6,0	40,91	ER40-6MICRO	5,0-6,0	52,33
ER40-7	6,0-7,0	40,91	ER40-7MICRO	6,0-7,0	52,33
ER40-8	7,0-8,0	40,91	ER40-8MICRO	7,0-8,0	52,33
ER40-9	8,0-9,0	40,91	ER40-9MICRO	8,0-9,0	52,33
ER40-10	9,0-10,0	40,91	ER40-10MICRO	9,0-10,0	52,33
ER40-11	10,0-11,0	40,91	ER40-11MICRO	10,0-11,0	52,33
ER40-12	11,0-12,0	40,91	ER40-12MICRO	11,0-12,0	52,33
ER40-13	12,0-13,0	40,91	ER40-13MICRO	12,0-13,0	52,33
ER40-14	13,0-14,0	40,91	ER40-14MICRO	13,0-14,0	52,33
ER40-15	14,0-15,0	40,91	ER40-15MICRO	14,0-15,0	52,33
ER40-16	15,0-16,0	40,91	ER40-16MICRO	15,0-16,0	52,33
ER40-17	16,0-17,0	40,91	ER40-17MICRO	16,0-17,0	52,33
ER40-18	17,0-18,0	40,91	ER40-18MICRO	17,0-18,0	52,33
ER40-19	18,0-19,0	40,91	ER40-19MICRO	18,0-19,0	52,33
ER40-20	19,0-20,0	40,91	ER40-20MICRO	19,0-20,0	52,33
ER40-21	20,0-21,0	40,91	ER40-21MICRO	20,0-21,0	52,33
ER40-22	21,0-22,0	40,91	ER40-22MICRO	21,0-22,0	52,33
ER40-23	22,0-23,0	40,91	ER40-23MICRO	22,0-23,0	52,33
ER40-24	23,0-24,0	40,91	ER40-24MICRO	23,0-24,0	52,33
ER40-25	24,0-25,0	40,91	ER40-25MICRO	24,0-25,0	52,33
ER40-26	25,0-26,0	40,91	ER40-26MICRO	25,0-26,0	52,33

PROFESSIONAL BLUE-MASTER SHARPENER

Ref. AFB10

*Includes case and spare grinding wheel



"Forgot electrical failures
of other sharpeners"
Anti short circuit devices

AFB10				
SHARPENING RANGE:				
POINT ANGLE:				
SHARPENING TYPES:				
RESHARPENING OF DRILLS:	HSS	HSSCo	SOLID CARBIDE	TiN
				CARBIDE TIPPED
				216,18 €

SHARP YOUR DRILLS IN 4 STEPS

1 Place and adjust the drill in the chuck



2 Sharpen the drill



3 Check the normal sharpening (Split Point)



4

CHUCK

PAFB10

26,38 €

GRINDING WHEEL

MAFB10

27,63 €

DRILL DOCTOR SHARPENERS

750X
High Precision



AFB1				
SHARPENING RANGE:	Ø 2,5-19			
POINT ANGLE:	118°	135°		
SHARPENING TYPES:				
RESHARPENING OF DRILLS:	HSS	HSSCo	SOLID CARBIDE	TiN
				CARBIDE TIPPED
				386,47 €

*Includes case

500X
Professional Sharpening



AFB2				
SHARPENING RANGE:	Ø 2,5-13			
POINT ANGLE:	118°	135°		
SHARPENING TYPES:				
RESHARPENING OF DRILLS:	HSS	HSSCo	SOLID CARBIDE	TiN
				CARBIDE TIPPED
				324,63 €

360X
Practical & Economic



AFB3				
SHARPENING RANGE:	Ø 2,5-13			
POINT ANGLE:	118°			
SHARPENING TYPES:				
RESHARPENING OF DRILLS:	HSS	HSSCo	SOLID CARBIDE	TiN
				CARBIDE TIPPED
				156,45 €

ACCESSORIES FOR SHARPENERS
DRILL SHARPENER CHUCKS

For 750X

AFB1PB

62,46 €



For 500X

AFB2PB

62,48 €



For 360X

AFB3PB

62,48 €

For
Left hand drill**AFB2PBI**

62,48 €

**COARSE GRINDSTONE
FOR 750X & 500X SHARPENER**
**AFBT**

59,77 €

**STANDARD GRINDSTONE
FOR 750X & 500X SHARPENER**
**AFBR**

59,77 €

SPARE SCREW FOR 750X & 500X
**AFBTLL**

6,85 €

EMPTY SPARE CASE FOR 750X, 500X & 360X
**AFBV**

28,27 €