

DRILL CHUCKS

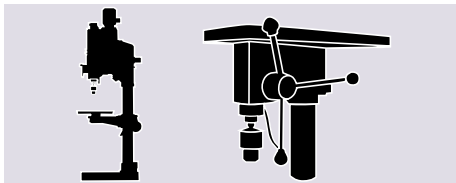

BLUE-MASTER[®]
by celesa

CUTTING TECHNOLOGIES

INDUSTRIAL CHUCKS FOR COLUMN OR CNC DRILLING MACHINE

**PREC.
<0,05**

Ref. DC1

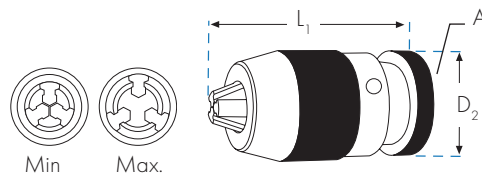
HIGH PRECISION



DC1						
	PRECISION mm	Min.-Max. mm	A	D ₂ mm	L ₁ mm	€
DC1-16-B16	<0,05	1-16	B16	53	119	173,92
DC1-20-B22	<0,05	5-20	B22	58	130	200,12

**PREC.
<0,12**

Ref. DC2

INDUSTRIAL

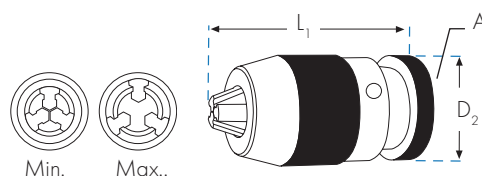

DC2						
	PRECISION mm	Min.-Max. mm	A	D ₂ mm	L ₁ mm	€
DC2-16-B18	<0,12	1-16	B18	53	119	147,56

**PREC.
<0,20**

Ref. DC3

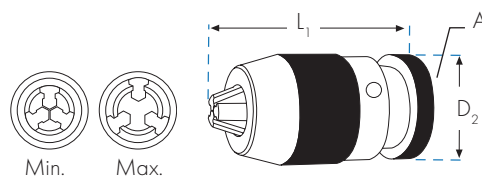
INDUSTRIAL
LIGHT-WEIGHT

DC3						
	PRECISION mm	Min.-Max. mm	A	D ₂ mm	L ₁ mm	€
DC3-13-B16	<0,20	1-13	B16	43	94	79,51
DC3-13-3/8	<0,20	1-13	3/8-24 UNF	43	94	79,51
DC3-13-1/2	<0,20	1-13	1/2-20 UNF	43	94	79,51
DC3-16-B16	<0,20	1-16	B16	48	119	123,41
DC3-16-B18	<0,20	1-16	B18	48	119	123,41

INDUSTRIAL TAPER SHANK CHUCKS FOR COLUMN OR CNC DRILLING MACHINE

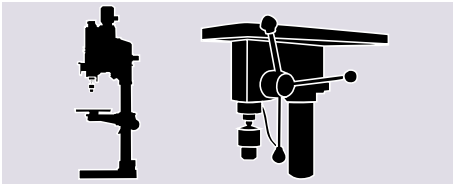

PREC. <0,05 Ref. DC10 **HIGH PRECISION**

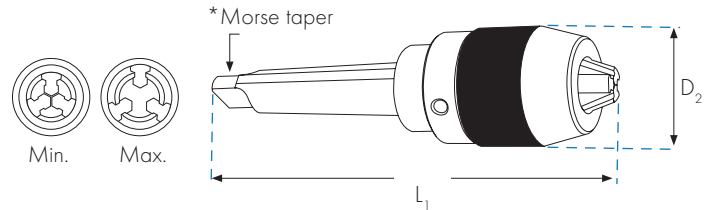

DC10						
	PRECISION mm	Min.-Max. mm	MT*	D2 mm	L1 mm	€
DC10-13-CM3	<0,05	1-13	MT3	51	192	256,53
DC10-13-CM4	<0,05	1-13	MT4	51	218	259,02
DC10-16-CM3	<0,05	1-16	MT3	56	207	262,29
DC10-16-CM4	<0,05	1-16	MT4	56	232	267,04

PREC. <0,12 Ref. DC11 **INDUSTRIAL**

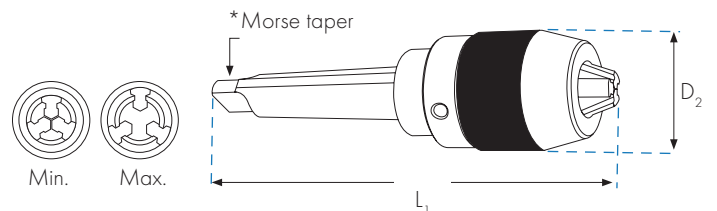

DC11						
	PRECISION mm	Min.-Max. mm	MT*	D2 mm	L1 mm	€
DC11-13-CM2	<0,12	1-13	MT2	51	174	154,90
DC11-13-CM3	<0,12	1-13	MT3	51	192	154,90
DC11-13-CM4	<0,12	1-13	MT4	51	218	154,90
DC11-16-CM3	<0,12	1-16	MT3	56	207	181,62

PROFESSIONAL AUTO-LOCK DRILL CHUCKS
<950W

Ref. DC4



- Auto-lock
- Plastic sleeve.
- Rotary and hammer mode drilling.

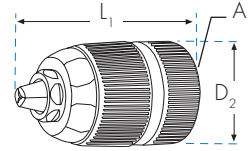
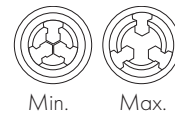

						DC4
	W	Min.-Max. mm	A	D2 mm	L1 mm	€
DC4-13-1/2	<950	1,5-13	1/2-20 UNF	43	75	36,87
DC4-13-1/2-SDS	<950	1,5-13	1/2-20 UNF	43	75	42,53

Ref. DC4-13-1/2-SDS

<1050W

Ref. DC5



- Auto-lock
- Metal sleeve
- High power
- Special jaws
- Rotary and hammer mode drilling.

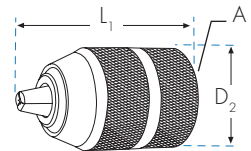
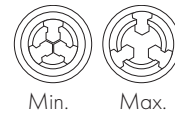

						DC5
	W	Min.-Max. mm	A	D2 mm	L1 mm	€
DC5-13-1/2	<1050	1,5-13	1/2-20 UNF	43	75	48,63
DC5-13-SDS	<1050	1,5-13	1/2-20 UNF	43	75	56,17

Ref. DC5-13-SDS

<950W

Ref. DC13



- Locking by tightening softly the drill chuck with the hand while spinning
- Designed for light power drill
- Plastic sleeve.



						DC13
	W	Min.-Max. mm	A	D2 mm	L1 mm	€
DC13-10-1/2	<950W	0,8-10	1/2-20 UNF	40	65	12,38

Ref. DC13-10-1/2

PROFESSIONAL KEY CHUCKS



Ref. DC6

- Rotary and hammer mode drilling.
- Key included.

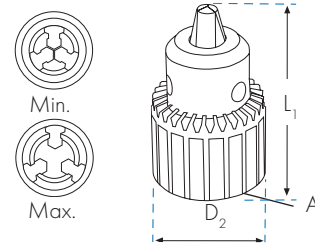

	Min.-Max. mm	A	D2 mm	L1 mm	DC6 €
DC6-06-B10	0,5-6,5	B10	31	50	36,98
DC6-06-3/8	0,5-6,5	3/8-24 UNF	31	50	36,98
DC6-10-1/2	1-10	1/2-20 UNF	37	60	28,96
DC6-13-B12	1-13	B12	46	78	37,87
DC6-13-3/8	1-13	3/8-24 UNF	46	78	37,87
DC6-16-B16	1-16	B16	57	95	42,33
DC6-16-B18	1-16	B18	57	95	42,33
DC6-16-1/2	1-16	1/2-20 UNF	57	95	42,33
DC6-19-B22	5-20	B22	68	115	57,92

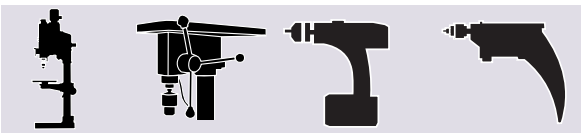

Ref. DC7

- Rotary and hammer mode drilling.
- Key included.

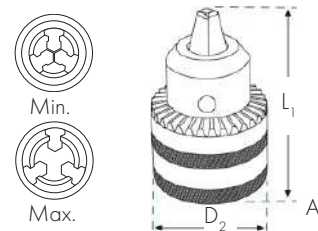

	Min.-Max. mm	A	D2 mm	L1 mm	DC7 €
DC7-06-B10	0,6-6,5	B10	30	50	15,88
DC7-06-3/8	0,6-6,5	3/8-24 UNF	30	50	15,88
DC7-10-1/2	1,5-10	1/2-20 UNF	33	59	14,56
DC7-13-B12	1,5-13	B12	42	70	18,45
DC7-13-B16	1,5-13	B16	42	70	18,45
DC7-13-3/8	1,5-13	3/8-24 UNF	42	70	18,45
DC7-13-1/2	1,5-13	1/2-20 UNF	42	70	18,45
DC7-13-SDS	1,5-13	1/2-20 UNF	42	70	19,41
DC7-16-1/2	3-16	1/2-20 UNF	51	87	23,30
DC7-16-5/8	3-16	5/8-16 UN	51	87	23,30

Ref. DC7-13-SDS

• For spare keys look at page 126.

DRILL CHUCK WITH FLEXIBLE EXTENSION

Ref. DC15-001

- 1050 mm length flexible extension
- Ø 1 to 6 mm auto-lock drill chuck.
- Max working speed: 6000 rpm.



DC15-001

	Min.-Max. mm	D2 mm	L1 mm	€
DC15-001	1-6	30	1050	34,13

90° ANGLE DRILL CHUCK

Ref. DC15-002

- For areas with limited access.
- Drill always in rotary mode.
- Ø 1 to 10 mm auto-lock drill chuck.
- Lightweight. For left or right-handed drilling.



DC15-002

	Min.-Max. mm	D2 mm	α	€
DC15-002	1-10	41	90°	19,98

PROFESSIONAL DRILL STAND

- Auto return feeding handle (it comes back to original position quickly, easily and without any extra effort).
- Drilling depth calibrated ruler, 60 mm drilling capacity.
- Drilling power tool holder with Ø43/38mm. Robust column with Ø40mm.
- Die cast base with guides for easy clamping of workpiece, and holes for installation of stand in any workbench.
- Precise and smooth drilling of round or flat workpieces.

Ref. STE99

**43/38
mm**

**60
mm**

**510
mm**

				STE99
	Ø Clamping mm	Drilling Depth mm	Height mm	€
STE99	43/38	60	510	64,80

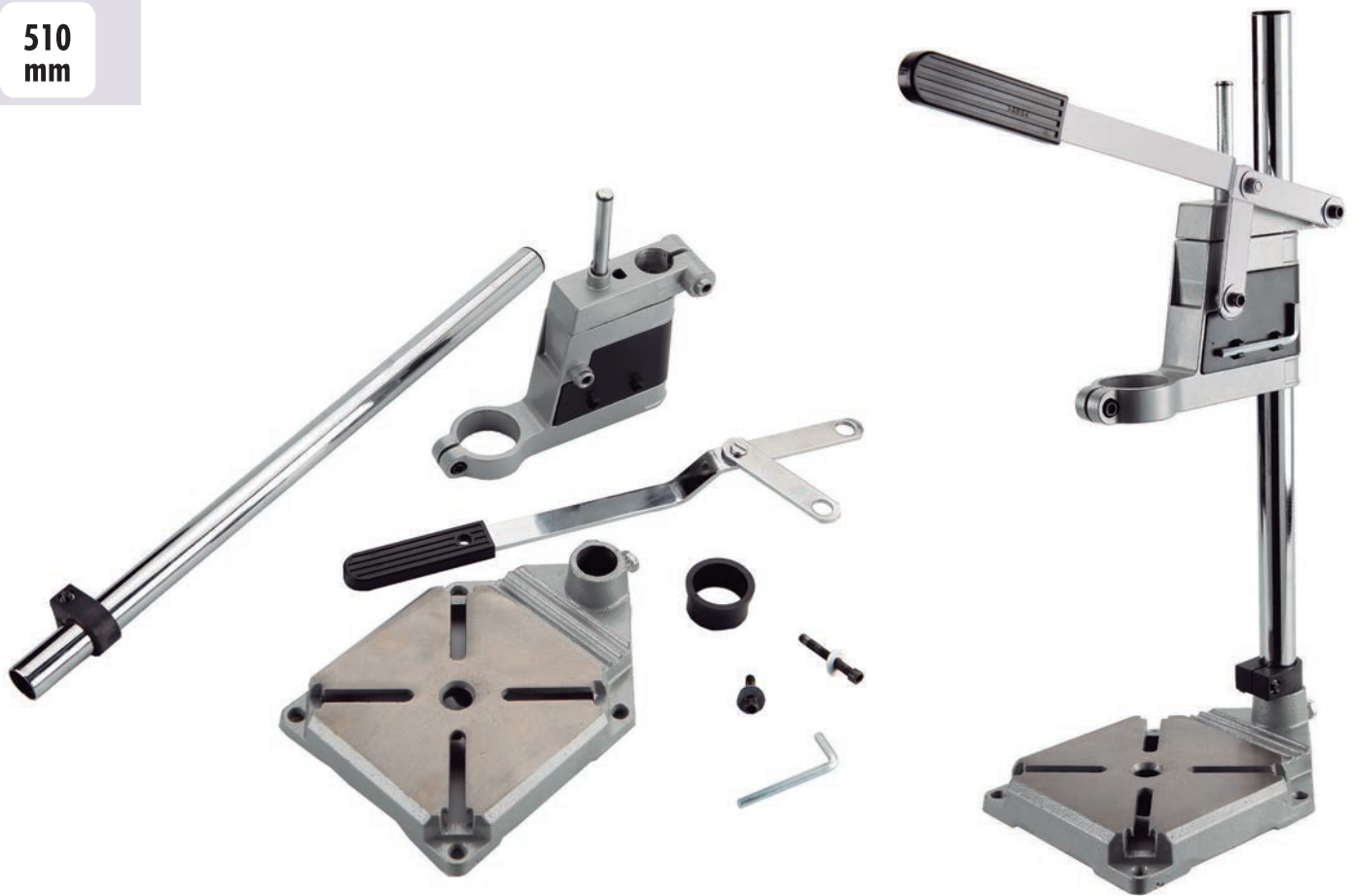

MACHINE AND MANUAL MINI DRILL CHUCKS

MACHINE MINI-DRILL CHUCK



P28

Includes 3 jaws:

- From 0 to 1 mm
- From 1 to 2 mm
- From 0,5 to 1,5 mm

15,81 €

HEX. SHANK MINI DRILL CHUCK



P29

- 1/4 Hex. Shank
- From 0,6 to 6,0 mm

17,94 €

ACCESSORIES FOR DRILL CHUCKS

DRILL CHUCK KEYS



	Min.-Max. mm	Ø mm	DC €
DC-10	1 - 10	6	4,30
DC-13	1 - 13	6	5,25
DC-16	1 - 16	8	6,53
DC-20	5 - 20	9	11,59

SDS-PLUS ADAPTER



	Thread	DC €
DC -3/8	3/8 - 24 UNF	14,57
DC -1/2	1/2 - 20 UNF	14,57

1/4" HEX. ADAPTER



	Shank	Thread	DC-01 €
DC-01	1/4" Hex.	3/8 - 24 UNF	8,43

DRILLS AND DRILL CHUCK ACCESSORIES

REDUCTION SLEEVES

DIN 2185



MORSE TAPER		L ₁ mm	CR		MORSE TAPER		L ₁ mm	CR	
EXT.	INT.		€		EXT.	INT.		€	
1	0	80	23,43		5	1	156	83,64	
2	1	92	23,11		5	2	156	76,34	
3	1	99	31,56		5	3	156	76,34	
3	2	112	32,16		5	4	171	77,94	
4	1	124	48,59		6	3	218	146,22	
4	2	124	45,66		6	4	218	165,91	
4	3	140	45,66		6	5	218	165,91	

INCREASE SOCKET

DIN 2187

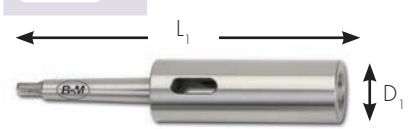

MORSE TAPER		L ₁ mm	D ₁ mm	CA	
EXT.	INT.			€	
1	2	160	30	48,53	
2	3	196	36	65,98	
3	4	240	48	111,27	
4	5	300	63	186,77	
5	6	415	80	524,89	

EXTENSION REDUCING SLEEVES

DIN 2187



MORSE TAPER		L ₁ mm	CA		MORSE TAPER		L ₁ mm	CA	
EXT.	INT.		€		EXT.	INT.		€	
2	1	160	32,65		5	2	247	151,86	
3	1	175	45,42		5	3	268	133,83	
3	2	194	49,02		5	4	300	151,26	
4	1	200	68,76		6	3	330	345,09	
4	2	215	67,21		6	4	355	345,09	
4	3	240	70,32		6	5	390	347,65	
5	1	232	167,04						

EXTENSION SLEEVES

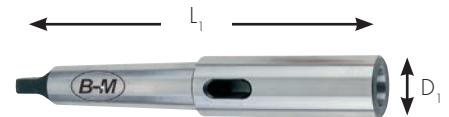

MORSE TAPER		L ₁ mm	D ₁ mm	CA	
EXT.	INT.			€	
1	1	145	20	31,76	
2	2	175	30	46,20	
3	3	215	36	69,98	
4	4	265	48	127,47	
5	5	335	63	240,12	
6	6	470	85	551,13	

TAPER DRILL CHUCK ARBOR

DIN 228

* MORSE TAPER

DIN 238

ARBOR

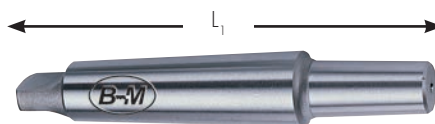

MT*	ARBOR	L ₁ mm	CM		MT*	ARBOR	L ₁ mm	CM	
			€					€	
1	B10	86	13,91		3	B22	147	26,04	
1	B12	89	10,45		3	B24	157	38,41	
1	B16	99	10,45		4	B16	158	23,26	
1	B18	107	11,98		4	B18	166	23,88	
2	B10	105	16,63		4	B22	176	42,95	
2	B12	106	12,70		4	B24	186	43,44	
2	B16	112	12,70		5	B16	193	84,24	
2	B18	119	12,70		5	B18	200	84,24	
2	B22	130	25,03		5	B22	208	87,87	
3	B12	127	19,12		5	B24	221	95,46	
3	B16	134	15,47		6	B22	240	179,50	
3	B18	140	15,47						

HOLDING-PIN EXTRACTOR B16 AND B18 FOR DRILL CHUCK CONES



CMEXT

46,76 €

DRILLS AND DRILL CHUCKS ACCESSORIES
DRILL DRIFTS
**DIN
317**



CE			
Nº	USEFULL FOR MT	L ₁ mm	€
0	0	90	13,90
1	1 / 2	140	16,43
3	3	190	21,69
4	4	225	29,51
5	5 / 6	265	47,92

**DIN
228**

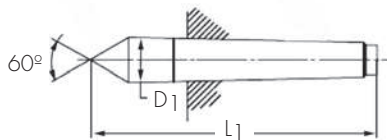
CMR				CMR			
	MORSE TAPER	A	€		MORSE TAPER	A	€
CMR1-3/8	1	3/8-24h	20,52	CMR2-5/8	2	5/8-16h	20,52
CMR1-1/2	1	1/2-20h	20,52	CMR3-3/8	3	3/8-24h	27,77
CMR2-3/8	2	3/8-24h	20,52	CMR3-1/2	3	1/2-20h	27,77
CMR2-1/2	2	1/2-20h	20,52	CMR3-5/8	3	5/8-16h	27,77

ACCESSORIES
LATHE CENTER

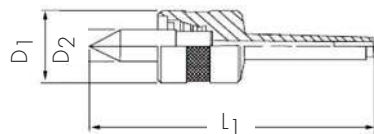
CPC				CPC..MD	
	D ₁ mm	L ₁ mm	MT* INT.	SOLID CARBIDE	€
CPCM1	12	80	1		
CPCM2	18	100	2	CPCM2-MD	57,58
CPCM3	24	125	3	CPCM3-MD	78,58
CPCM4	31	160	4	CPCM4-MD	95,84
CPCM5	44	200	5	CPCM5-MD	162,93
CPCM6	63	270	6		

LIVE CENTER

PGC					
	D ₁ mm	D ₂ mm	L ₁ mm	MT*	€
PGCM1	34	18	120	1	144,23
PGCM2	50	21	148	2	160,86
PGCM3	60	24	185	3	216,26
PGCM4	63	30	220	4	256,31
PGCM5	75	44	260	5	370,45

TAP HOLDERS

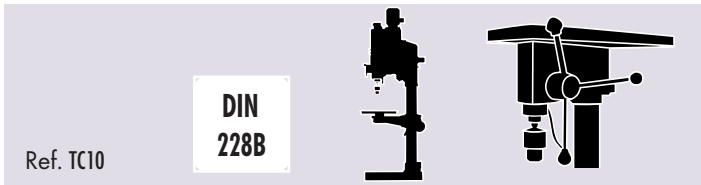

Ref. TC10

**DIN
228B**

- With longitudinal compensation in compression and traction
- Taper Shank

						TC10
	D1 mm	D3 mm	L1 mm	L2 mm	MORSE TAPER	€
TC10-19-CM2	36	19	122	47	2	307,14
TC10-19-CM3	36	19	141	47	3	392,42
TC10-31-CM3	53	31	165	71	3	504,96
TC10-31-CM4	53	31	189	72	4	562,67
TC10-48-CM4	78	48	222	105	4	851,21
TC10-48-CM5	78	48	255	106	5	908,92



TAP HOLDER WITHOUT CLUTCH

TAP HOLDER WITH CLUTCH

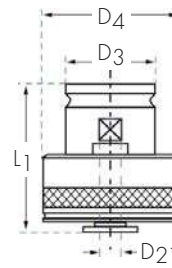
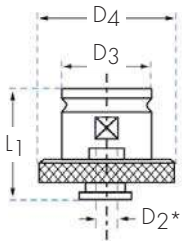

					TC15
	D2 mm	D3 mm	L1 mm	D4 mm	€
TC15-19-035	3,5	19	28	30	41,13
TC15-19-040	4,0	19	28	30	41,13
TC15-19-045	4,5	19	28	30	41,13
TC15-19-060	6,0	19	28	30	41,13
TC15-19-070	7,0	19	28	30	41,13
TC15-19-080	8,0	19	28	30	41,13
TC15-19-090	9,0	19	28	30	41,13
TC15-19-100	10,0	19	28	30	41,13
TC15-31-070	7,0	31	46	48	57,74
TC15-31-080	8,0	31	46	48	57,74
TC15-31-090	9,0	31	46	48	57,74
TC15-31-100	10,0	31	46	48	57,74
TC15-31-110	11,0	31	46	48	57,74
TC15-31-120	12,0	31	46	48	57,74
TC15-31-140	14,0	31	46	48	57,74
TC15-31-160	16,0	31	46	48	57,74
TC15-48-110	11,0	48	69	70	152,98
TC15-48-120	12,0	48	69	70	152,98
TC15-48-140	14,0	48	69	70	152,98
TC15-48-160	16,0	48	69	70	152,98
TC15-48-180	18,0	48	69	70	152,98
TC15-48-200	20,0	48	69	70	152,98
TC15-48-220	22,0	48	69	70	152,98
TC15-48-250	25,0	48	69	70	152,98
TC15-48-280	28,0	48	69	70	152,98

					TC16
	D2 mm	D3 mm	L1 mm	D4 mm	€
TC16-19-035	3,5	19	46	32	98,71
TC16-19-040	4,0	19	46	32	98,71
TC16-19-045	4,5	19	46	32	98,71
TC16-19-060	6,0	19	46	32	98,71
TC16-19-070	7,0	19	46	32	98,71
TC16-19-080	8,0	19	46	32	98,71
TC16-19-090	9,0	19	46	32	98,71
TC16-19-100	10,0	19	46	32	98,71
TC16-31-070	7,0	31	69	50	125,02
TC16-31-080	8,0	31	69	50	125,02
TC16-31-090	9,0	31	69	50	125,02
TC16-31-100	10,0	31	69	50	125,02
TC16-31-110	11,0	31	69	50	125,02
TC16-31-120	12,0	31	69	50	125,02
TC16-31-140	14,0	31	69	50	125,02
TC16-31-160	16,0	31	69	50	125,02
TC16-48-110	11,0	48	100	70	276,79
TC16-48-120	12,0	48	100	70	276,79
TC16-48-140	14,0	48	100	70	276,79
TC16-48-160	16,0	48	100	70	276,79
TC16-48-180	18,0	48	100	70	276,79
TC16-48-200	20,0	48	100	70	276,79
TC16-48-220	22,0	48	100	70	276,79
TC16-48-250	25,0	48	100	70	276,79
TC16-48-280	28,0	48	100	70	276,79

* D2: Ø of the shank of the tap
 * To get information about the Ø of the shank of the tap please consult pag 130.

TAPS SUITABLES FOR TAP HOLDER WITH/WITHOUT CLUTCH
D2 mm.

3,5	4	4,5	6	7	8	9	10	11
M3x0,50R	M3,5x0,60R	M4x0,50R	M4,5x0,50R	M9x1,00D	M8x1,25R	M9x1,25R	M10x1,50R	M13x0,75D
M3x0,60R	M3,5x0,75R	M4x0,70R	M4,5x0,75R	M9x1,25D	M11x0,75D	M12x0,75D		M13x1,00D
M5x0,50D		M4x0,75R	M5x0,50R	M10x0,50D	M11x1,00D	M12x1,00D		M13x1,25D
M5x0,75D		M4x0,80R	M5x0,75R	M10x0,75D	M11x1,25D	M12x1,25D		M13x1,50D
M5x0,80D		M6x0,50D	M5x0,80R	M10x1,00D	M11x1,50D	M12x1,50D		M13x1,75D
M5x0,90D		M6x0,75D	M5x0,90R	M10x1,25D		M12x1,75D		M14x0,75D
		M6x1,00D	M5x1,00R	M10x1,50D				M14x1,00D
			M5,5x0,90R					M14x1,25D
			M6x0,50R					M14x1,50D
			M6x0,75R					M14x2,00D
			M6x1,00R					
			M6x1,25R					
			M8x0,50D					
			M8x0,75D					
			M8x1,00D					
			M8x1,25D					
			M8x1,50D					

D2 mm.

12	14	16	18	20	22	25	28
M15x1,00D	M18x1,00D	M20x1,00D	M22x1,00D	M27x1,00D	M30x1,00D	M33x1,00D	M34x1,50D
M15x1,25D	M18x1,25D	M20x1,25D	M22x1,25D	M27x1,50D	M30x1,50D	M33x1,50D	M34x2,00D
M15x1,50D	M18x1,50D	M20x1,50D	M22x1,50D	M27x2,00D	M30x2,00D	M33x2,00D	M35x1,50D
M15x2,00D	M18x2,00D	M20x2,00D	M22x2,00D	M27x3,00D	M30x3,00D	M33x3,50D	M35x2,00D
M16x1,00D	M18x2,50D	M20x2,50D	M22x2,50D	M28x1,00D	M30x3,50D		M36x1,50D
M16x1,25D	M19x1,00D	M21x1,00D	M23x1,00D	M28x1,50D	M32x1,00D		M36x2,00D
M16x1,50D	M19x1,25D	M21x1,25D	M23x1,50D	M28x2,00D	M32x1,50D		M36x3,00D
M16x2,00D	M19x1,50D	M21x1,50D	M24x1,00D		M32x2,00D		M36x4,00D
M17x1,00D	M19x2,00D		M24x1,25D				M38x1,50D
M17x1,25D			M24x1,50D				M38x2,00D
M17x1,50D			M24x2,00D				
			M24x3,00D				
			M25x1,00D				
			M25x1,25D				
			M25x1,50D				
			M25x2,00D				
			M26x1,00D				
			M26x1,50D				
			M26x2,00D				

- * D2: Ø of the shank of the tap
- * Chart is for taps DIN 371/374/DIN376
- * R: Reinforced
- * D: Straight

PRECISION COLLET

Ref. ER8

TYPE
ER

DIN
6499-B

Collets to be used in cutting tools with plain straight shank.

D2: 8,5
L1: 13,5

α : 8°
 β : 30°

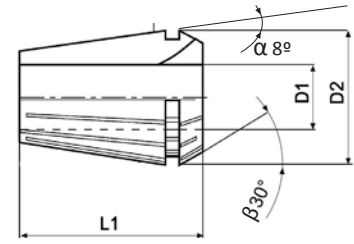

ER8

	EXC 0,01 INDUSTRIAL		EXC 0,005 HIGH PRECISION		
	Capacity D1	€	Capacity D1	€	
ER8-1	0,5-1,0	50,47	ER8-1MICRO	0,5-1,0	-
ER8-1,5	1,0-1,5	50,47	ER8-1,5MICRO	1,0-1,5	-
ER8-2	1,5-2,0	43,25	ER8-2MICRO	1,5-2,0	-
ER8-2,5	2,0-2,5	43,25	ER8-2,5MICRO	2,0-2,5	-
ER8-3	2,5-3,0	37,97	ER8-3MICRO	2,5-3,0	-
ER8-3,5	3,0-3,5	37,97	ER8-3,5MICRO	3,0-3,5	-
ER8-4	3,5-4,0	37,97	ER8-4MICRO	3,5-4,0	-
ER8-4,5	4,0-4,5	37,97	ER8-4,5MICRO	4,0-4,5	-
ER8-5	4,5-5,0	37,97	ER8-5MICRO	4,5-5,0	-

Ref. ER11

TYPE
ER

DIN
6499-B

D2: 11,5
L1: 18

α : 8°
 β : 30°

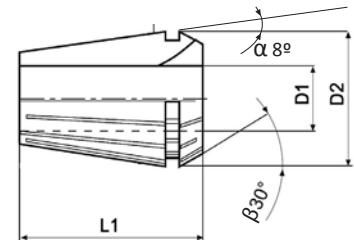

ER11

	EXC 0,01 INDUSTRIAL		EXC 0,005 HIGH PRECISION		
	Capacity D1	€	Capacity D1	€	
ER11-1	0,5-1,0	48,06	ER11-1MICRO	0,5-1,0	-
ER11-1,5	1,0-1,5	48,06	ER11-1,5MICRO	1,0-1,5	-
ER11-2	1,5-2,0	41,20	ER11-2MICRO	1,5-2,0	-
ER11-2,5	2,0-2,5	41,20	ER11-2,5MICRO	2,0-2,5	-
ER11-3	2,5-3,0	36,17	ER11-3MICRO	2,5-3,0	-
ER11-3,5	3,0-3,5	36,17	ER11-3,5MICRO	3,0-3,5	51,78
ER11-4	3,5-4,0	36,17	ER11-4MICRO	3,5-4,0	51,78
ER11-4,5	4,0-4,5	36,17	ER11-4,5MICRO	4,0-4,5	51,78
ER11-5	4,5-5,0	36,17	ER11-5MICRO	4,5-5,0	51,78
ER11-5,5	5,0-5,5	36,17	ER11-5,5MICRO	5,0-5,5	51,78
ER11-6	5,5-6,0	36,17	ER11-6MICRO	5,5-6,0	51,78
ER11-6,5	6,0-6,6	36,17	ER11-6,5MICRO	6,0-6,6	51,78
ER11-7	6,5-7,0	36,17	ER11-7MICRO	6,5-7,0	51,78

PRECISION COLLET

Ref. ER16

TYPE
ER
DIN
6499-B

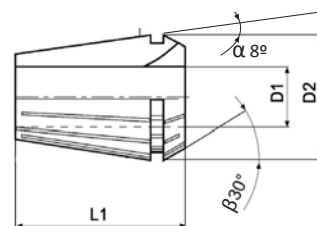
 D2: 17 α : 8°
 L1: 27,5 β : 30°

ER16

	EXC 0,01 INDUSTRIAL		EXC 0,005 HIGH PRECISION		
	Capacity D1	€	Capacity D1	€	
ER16-1	0,5-1,0	43,06	ER16-1 MICRO	0,5-1,0	-
ER16-2	1,0-2,0	38,77	ER16-2 MICRO	1,0-2,0	-
ER16-3	2,0-3,0	34,88	ER16-3 MICRO	2,0-3,0	-
ER16-4	3,0-4,0	34,88	ER16-4 MICRO	3,0-4,0	46,11
ER16-5	4,0-5,0	34,88	ER16-5 MICRO	4,0-5,0	46,11
ER16-6	5,0-6,0	34,88	ER16-6 MICRO	5,0-6,0	46,11
ER16-7	6,0-7,0	34,88	ER16-7 MICRO	6,0-7,0	46,11
ER16-8	7,0-8,0	34,88	ER16-8 MICRO	7,0-8,0	46,11
ER16-9	8,0-9,0	34,88	ER16-9 MICRO	8,0-9,0	46,11
ER16-10	9,0-10,0	34,88	ER16-10 MICRO	9,0-10,0	46,11

Ref. ER25

TYPE
ER
DIN
6499-B

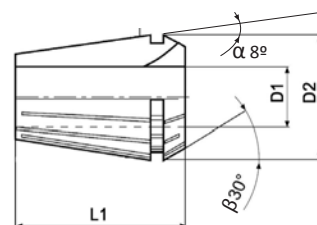
 D2: 26 α : 8°
 L1: 34 β : 30°

ER25

	EXC 0,01 INDUSTRIAL		EXC 0,005 HIGH PRECISION		
	Capacity D1	€	Capacity D1	€	
ER25-2	1,0-2,0	39,94	ER25-2 MICRO	1,0-2,0	-
ER25-3	2,0-3,0	39,94	ER25-3 MICRO	2,0-3,0	-
ER25-4	3,0-4,0	39,94	ER25-4 MICRO	3,0-4,0	49,66
ER25-5	4,0-5,0	39,94	ER25-5 MICRO	4,0-5,0	49,66
ER25-6	5,0-6,0	39,94	ER25-6 MICRO	5,0-6,0	49,66
ER25-7	6,0-7,0	39,94	ER25-7 MICRO	6,0-7,0	49,66
ER25-8	7,0-8,0	39,94	ER25-8 MICRO	7,0-8,0	49,66
ER25-9	8,0-9,0	39,94	ER25-9 MICRO	8,0-9,0	49,66
ER25-10	9,0-10,0	39,94	ER25-10 MICRO	9,0-10,0	49,66
ER25-11	10,0-11,0	39,94	ER25-11 MICRO	10,0-11,0	49,66
ER25-12	11,0-12,0	39,94	ER25-12 MICRO	11,0-12,0	49,66
ER25-13	12,0-13,0	39,94	ER25-13 MICRO	12,0-13,0	49,66
ER25-14	13,0-14,0	39,94	ER25-14 MICRO	13,0-14,0	49,66
ER25-15	14,0-15,0	39,94	ER25-15 MICRO	14,0-15,0	49,66
ER25-16	15,0-16,0	39,94	ER25-16 MICRO	15,0-16,0	49,66

PRECISION COLLET

Ref. ER32

TYPE
ER

DIN
6499-B

D2: 33
L1: 40

α : 8°
 β : 30°

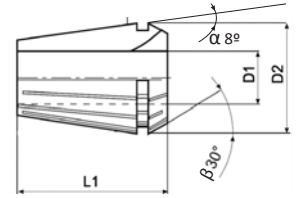

ER32

	EXC 0,01 INDUSTRIAL		EXC 0,005 HIGH PRECISION		
	Capacity D1	€	Capacity D1	€	
ER32-3	2,0-3,0	37,96	ER32-3MICRO	2,0-3,0	-
ER32-4	3,0-4,0	37,96	ER32-4MICRO	3,0-4,0	51,85
ER32-5	4,0-5,0	37,96	ER32-5MICRO	4,0-5,0	51,85
ER32-6	5,0-6,0	37,96	ER32-6MICRO	5,0-6,0	51,85
ER32-7	6,0-7,0	37,96	ER32-7MICRO	6,0-7,0	51,85
ER32-8	7,0-8,0	37,96	ER32-8MICRO	7,0-8,0	51,85
ER32-9	8,0-9,0	37,96	ER32-9MICRO	8,0-9,0	51,85
ER32-10	9,0-10,0	37,96	ER32-10MICRO	9,0-10,0	51,85
ER32-11	10,0-11,0	37,96	ER32-11MICRO	10,0-11,0	51,85
ER32-12	11,0-12,0	37,96	ER32-12MICRO	11,0-12,0	51,85
ER32-13	12,0-13,0	37,96	ER32-13MICRO	12,0-13,0	51,85
ER32-14	13,0-14,0	37,96	ER32-14MICRO	13,0-14,0	51,85
ER32-15	14,0-15,0	37,96	ER32-15MICRO	14,0-15,0	51,85
ER32-16	15,0-16,0	37,96	ER32-16MICRO	15,0-16,0	51,85
ER32-17	16,0-17,0	37,96	ER32-17MICRO	16,0-17,0	51,85
ER32-18	17,0-18,0	37,96	ER32-18MICRO	17,0-18,0	51,85
ER32-19	18,0-19,0	37,96	ER32-19MICRO	18,0-19,0	51,85
ER32-20	19,0-20,0	37,96	ER32-20MICRO	19,0-20,0	51,85

Ref. ER40

TYPE
ER

DIN
6499-B

D2: 41
L1: 46

α : 8°
 β : 30°

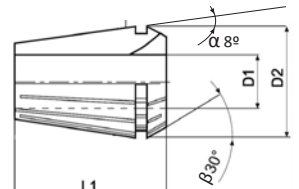

ER40

	EXC 0,01 INDUSTRIAL		EXC 0,005 HIGH PRECISION		
	Capacity D1	€	Capacity D1	€	
ER40-3	2,0-3,0	48,24	ER40-3MICRO	2,0-3,0	-
ER40-4	3,0-4,0	48,24	ER40-4MICRO	3,0-4,0	61,70
ER40-5	4,0-5,0	48,24	ER40-5MICRO	4,0-5,0	61,70
ER40-6	5,0-6,0	48,24	ER40-6MICRO	5,0-6,0	61,70
ER40-7	6,0-7,0	48,24	ER40-7MICRO	6,0-7,0	61,70
ER40-8	7,0-8,0	48,24	ER40-8MICRO	7,0-8,0	61,70
ER40-9	8,0-9,0	48,24	ER40-9MICRO	8,0-9,0	61,70
ER40-10	9,0-10,0	48,24	ER40-10MICRO	9,0-10,0	61,70
ER40-11	10,0-11,0	48,24	ER40-11MICRO	10,0-11,0	61,70
ER40-12	11,0-12,0	48,24	ER40-12MICRO	11,0-12,0	61,70
ER40-13	12,0-13,0	48,24	ER40-13MICRO	12,0-13,0	61,70
ER40-14	13,0-14,0	48,24	ER40-14MICRO	13,0-14,0	61,70
ER40-15	14,0-15,0	48,24	ER40-15MICRO	14,0-15,0	61,70
ER40-16	15,0-16,0	48,24	ER40-16MICRO	15,0-16,0	61,70
ER40-17	16,0-17,0	48,24	ER40-17MICRO	16,0-17,0	61,70
ER40-18	17,0-18,0	48,24	ER40-18MICRO	17,0-18,0	61,70
ER40-19	18,0-19,0	48,24	ER40-19MICRO	18,0-19,0	61,70
ER40-20	19,0-20,0	48,24	ER40-20MICRO	19,0-20,0	61,70
ER40-21	20,0-21,0	48,24	ER40-21MICRO	20,0-21,0	61,70
ER40-22	21,0-22,0	48,24	ER40-22MICRO	21,0-22,0	61,70
ER40-23	22,0-23,0	48,24	ER40-23MICRO	22,0-23,0	61,70
ER40-24	23,0-24,0	48,24	ER40-24MICRO	23,0-24,0	61,70
ER40-25	24,0-25,0	48,24	ER40-25MICRO	24,0-25,0	61,70
ER40-26	25,0-26,0	48,24	ER40-26MICRO	25,0-26,0	61,70

PROFESSIONAL BLUE-MASTER SHARPENER

*Includes case and spare grinding wheel



Ref. AFB10



Forget about the electrical failures of other sharpeners
Anti short circuit devices

AFB10				
SHARPENING RANGE:	Ø			
	3-13			
POINT ANGLE:				
	118°			
SHARPENING TYPES:				
RESHARPENING OF DRILLS:	HSS	HSSCo	SOLID CARBIDE	TIN
				CARBIDE TIPPED
274,80 €				

SHARP YOUR DRILLS IN 4 STEPS

1

Place and adjust the drill in the chuck



2

Sharpen the drill



3

Check the normal sharpening



4

Split Point sharpening

CHUCK

PAFB10
32,28 €

GRINDING WHEEL

MAFB10
33,80 €

DRILL DOCTOR SHARPENERS

750X
High Precision



AFB1					
SHARPENING RANGE:	Ø 2,5-19				
POINT ANGLE:	118°	135°			
SHARPENING TYPES:					
RESHARPENING OF DRILLS:	HSS	HSSCo	SOLID CARBIDE	TiN	CARBIDE TIPPED
				505,04 €	

*Includes pouch

500X
Professional Sharpening



AFB2					
SHARPENING RANGE:	Ø 2,5-13				
POINT ANGLE:	118°	135°			
SHARPENING TYPES:					
RESHARPENING OF DRILLS:	HSS	HSSCo	SOLID CARBIDE	TiN	CARBIDE TIPPED
				424,22 €	

XP
Practical & Economic



AFB3					
SHARPENING RANGE:	Ø 2,5-13				
POINT ANGLE:	118°				
SHARPENING TYPES:					
RESHARPENING OF DRILLS:	HSS	HSSCo	SOLID CARBIDE	TiN	CARBIDE TIPPED
				204,44 €	

ACCESSORIES FOR SHARPENERS
DRILL SHARPENER CHUCKS

For 750X

 AFB1PB
 76,43 €

*For
Left hand drill*

 AFB2PBI
 76,45 €

COARSE GRINDSTONE FOR 750X & 500X SHARPENER

 AFBT
 71,01 €

 AFBR
 71,01 €

SPARE SCREW FOR 750X & 500X

 AFBTLL
 8,38 €

AFB10 SUPPORT

 SOPAFB10
 30,25 €