

BLUE-MASTER®
by *celesa*

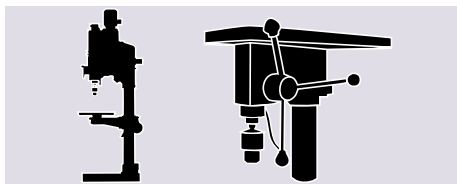

MANDRINI

MANDRINI INDUSTRIALI PER TRAPANI A COLONNA O CNC

**PREC.
<0,05**

Ref. DC1

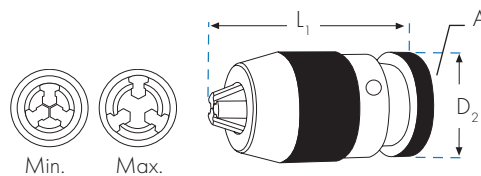
ALTA PRECISIONE



| DC1 | | | | | | |
|------------|------------------|-----------------|-----|----------|----------|--------|
| | PRECISIONE mm | Min.-Max. mm | A | D2 mm | L1 mm | € |
| DC1-20-B22 | <0,05 | 5-20 | B22 | 58 | 130 | 206,12 |

**PREC.
<0,20**

Ref. DC3

INDUSTRIALE LEGGERO

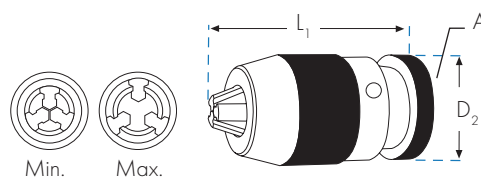

| DC3 | | | | | | |
|------------|------------------|-----------------|------------|----------|----------|--------|
| | PRECISIONE mm | Min.-Max. mm | A | D2 mm | L1 mm | € |
| DC3-13-B16 | <0,20 | 1-13 | B16 | 43 | 94 | 77,62 |
| DC3-13-3/8 | <0,20 | 1-13 | 3/8-24 UNF | 43 | 94 | 77,62 |
| DC3-13-1/2 | <0,20 | 1-13 | 1/2-20 UNF | 43 | 94 | 77,62 |
| DC3-16-B16 | <0,20 | 1-16 | B16 | 48 | 119 | 120,48 |
| DC3-16-B18 | <0,20 | 1-16 | B18 | 48 | 119 | 120,48 |

MANDRINI INDUSTRIALI CON CODOLO CONICO PER TRAPANI A COLONNA O CNC

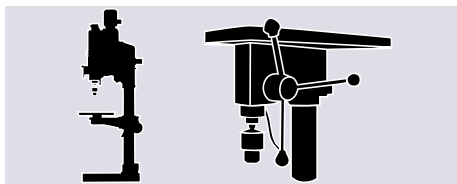

**PREC.
<0,05**

Ref. DC10

ALTA PRECISIONE

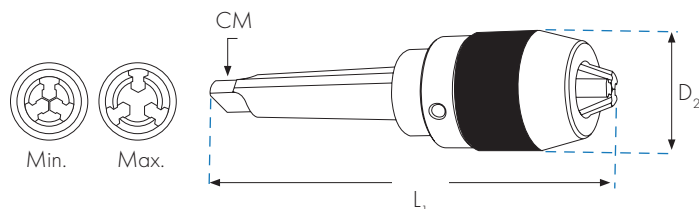

| | | | | | | DC10 |
|-------------|------------------|-----------------|-----|----------------------|----------------------|--------|
| | PRECISIONE mm | Mín.-Max. mm | CM | D ₂ mm | L ₁ mm | € |
| DC10-13-CM3 | <0,05 | 1-13 | CM3 | 51 | 192 | 264,23 |
| DC10-13-CM4 | <0,05 | 1-13 | CM4 | 51 | 218 | 266,79 |
| DC10-16-CM3 | <0,05 | 1-16 | CM3 | 56 | 207 | 270,16 |

**PREC.
<0,12**

Ref. DC11

INDUSTRIALE

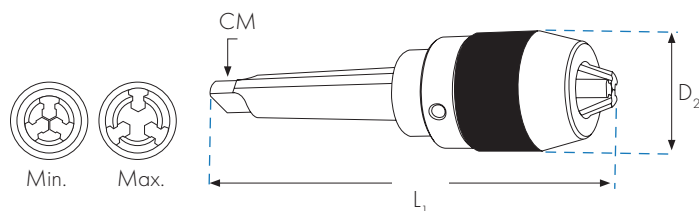

| | | | | | | DC11 |
|-------------|------------------|-----------------|-----|----------------------|----------------------|--------|
| | PRECISIONE mm | Mín.-Max. mm | CM | D ₂ mm | L ₁ mm | € |
| DC11-13-CM2 | <0,12 | 1-13 | CM2 | 51 | 174 | 159,55 |
| DC11-13-CM3 | <0,12 | 1-13 | CM3 | 51 | 192 | 159,55 |
| DC11-13-CM4 | <0,12 | 1-13 | CM4 | 51 | 218 | 159,55 |
| DC11-16-CM3 | <0,12 | 1-16 | CM3 | 56 | 207 | 187,07 |

CHIAVE PERNO PER MANDRINO DC11



| NEW | | | | | DC20 |
|------------|-----------------|----------------------|----------------------|-------|------|
| | Mín.-Max. mm | D ₂ mm | L ₁ mm | € | |
| DC20-1 | 1-13 | 4-5 | 180 | 11,59 | |
| DC20-2 | 1-16 | 4-5 | 190 | 13,65 | |

MANDRINI AUTOMATICI PROFESSIONALI
<950W

Ref. DC4



- Bloccaggio automatico.
- Corpo in plastica.
- Per trapano sia in modalità a rotazione sia a percussione.

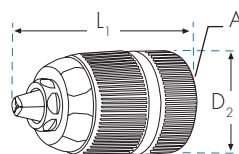
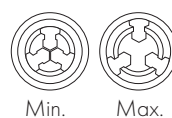

| | | | | | | DC4 |
|----------------|------|--------------|------------|-------|-------|-------|
| | W | Min.-Max. mm | A | D2 mm | L1 mm | € |
| DC4-13-1/2 | <950 | 1,5-13 | 1/2-20 UNF | 43 | 75 | 47,46 |
| DC4-13-1/2-SDS | <950 | 1,5-13 | 1/2-20 UNF | 43 | 75 | 54,75 |

Ref. DC4-13-1/2-SDS

<1050W

Ref. DC5



- Bloccaggio automatico.
- Corpo in metallo.
- Alta potenza.
- Ganasce speciali per alto rendimento.
- Per trapano sia in modalità a rotazione sia a percussione.

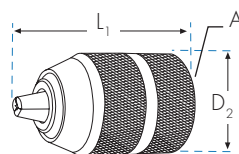
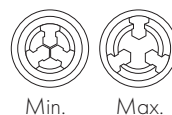

| | | | | | | DC5 |
|------------|-------|--------------|------------|-------|-------|-------|
| | W | Min.-Max. mm | A | D2 mm | L1 mm | € |
| DC5-13-1/2 | <1050 | 1,5-13 | 1/2-20 UNF | 43 | 75 | 55,42 |
| DC5-13-SDS | <1050 | 1,5-13 | 1/2-20 UNF | 43 | 75 | 63,64 |

Ref. DC5-13-SDS

<950W

Ref. DC13



- Si blocca ruotando il trapano ed esercitando una leggera pressione sul mandrino con la mano.
- Pensato per trapani leggeri a batteria.
- Corpo in plastica.



| | | | | | | DC13 |
|-------------|-------|--------------|------------|-------|-------|-------|
| | W | Min.-Max. mm | A | D2 mm | L1 mm | € |
| DC13-10-1/2 | <950W | 0,8-10 | 1/2-20 UNF | 40 | 65 | 12,75 |

Ref. DC13-10-1/2

MANDRINI CON CHIAVE PROFESSIONALI



Ref. DC6

- Supporta la percussione, si consiglia l'uso in modalità a rotazione.
- Chiave inclusa

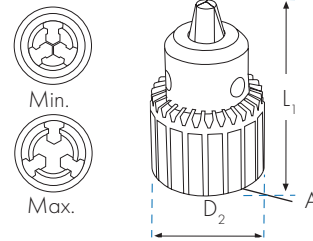

| | Min.-Max. mm | A | D2 mm | L1 mm | DC6 € |
|------------|--------------|------------|-------|-------|-------|
| DC6-06-B10 | 0,5-6,5 | B10 | 31 | 50 | 38,09 |
| DC6-06-3/8 | 0,5-6,5 | 3/8-24 UNF | 31 | 50 | 38,09 |
| DC6-10-1/2 | 1-10 | 1/2-20 UNF | 37 | 60 | 29,83 |
| DC6-13-B12 | 1-13 | B12 | 46 | 78 | 38,09 |
| DC6-13-3/8 | 1-13 | 3/8-24 UNF | 46 | 78 | 55,07 |
| DC6-16-B16 | 1-16 | B16 | 57 | 95 | 46,15 |
| DC6-19-B22 | 5-20 | B22 | 68 | 115 | 63,17 |

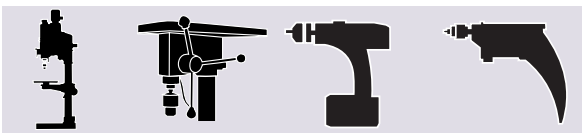

Ref. DC7

LEGGERO

- Per trapano sia in modalità a rotazione sia a percussione.
- Chiave inclusa

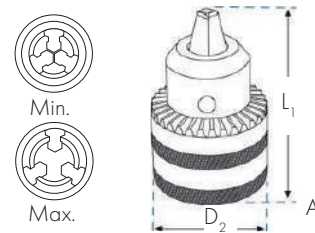

Ref. DC7-13-SDS

| | Min.-Max. mm | A | D2 mm | L1 mm | DC7 € |
|------------|--------------|------------|-------|-------|-------|
| DC7-06-B10 | 0,6-6,5 | B10 | 30 | 50 | 16,36 |
| DC7-06-3/8 | 0,6-6,5 | 3/8-24 UNF | 30 | 50 | 16,36 |
| DC7-10-1/2 | 1,5-10 | 1/2-20 UNF | 33 | 59 | 16,01 |
| DC7-13-B12 | 1,5-13 | B12 | 42 | 70 | 19,00 |
| DC7-13-B16 | 1,5-13 | B16 | 42 | 70 | 17,82 |
| DC7-13-3/8 | 1,5-13 | 3/8-24 UNF | 42 | 70 | 16,62 |
| DC7-13-1/2 | 1,5-13 | 1/2-20 UNF | 42 | 70 | 16,62 |
| DC7-13-SDS | 1,5-13 | 1/2-20 UNF | 42 | 70 | 19,50 |
| DC7-16-1/2 | 3-16 | 1/2-20 UNF | 51 | 87 | 24,00 |

MANDRINO CON PROLUNGA FLESSIBILE

Ref. DC15-001

- Prolunga flessibile di 1050 mm.
- Mandrino automatico da Ø1 a 6 mm di capacità.
- Velocità massima di lavoro 6000 rpm.



| DC15-001 | | | | |
|----------|-----------------|----------|----------|-------|
| | Min.-Max. mm | D2 mm | L1 mm | € |
| DC15-001 | 1-6 | 30 | 1050 | 35,15 |

MANDRINO AD ANGOLO

Ref. DC15-002

- Indicato per lavorare in luoghi di difficile accesso.
- Uso esclusivo in modalità a rotazione.
- Mandrino automatico da Ø 1 a 10 mm di capacità.
- Design leggero. Include impugnatura per mancini e destri.



| DC15-002 | | | | |
|----------|-----------------|----------|-----|-------|
| | Min.-Max. mm | D2 mm | α | € |
| DC15-002 | 1-10 | 41 | 90° | 20,58 |

MINI MANDRINO CODOLO ESAGONALE



P29

- Codolo 1/4 Esagonale
- Da 0,6 a 6,0 mm

18,48

SUPPORTO A COLONNA PROFESSIONALE PER TRAPANO

- Maniglia con molla di richiamo integrata (recupera la posizione in modo rapido, semplice e senza alcuno sforzo).
- Regola di controllo di forazione, 60 mm di profondità.
- Supporto a colonna professionale per trapano con Ø 43/38 mm.
- Base in ghisa grigia con guide per morsa di stringimento e fori per ancoraggio al banco da lavoro.
- Forazione precisa di superficie, pezzi da lavorare rotondi o listelli.

Ref. STE99

**43/38
mm**

**60
mm**

**510
mm**

| | | | | STE99 |
|-------|-----------------|----------------------------|---------------|-------|
| | Ø Attacco mm | Profondità forazione mm | Altezza mm | € |
| STE99 | 43/38 | 60 | 510 | 66,74 |



ACCESSORI PER PUNTE E MANDRINI
CHIAVI PER MANDRINI

ADATTATORI SDS PLUS

ADATTATORE 1/4" ESAGONALE

| DC | | | |
|-------|-----------------|---------|-------|
| | Min.-Max. mm | Ø mm | € |
| DC-10 | 1 - 10 | 6 | 4,55 |
| DC-13 | 1 - 13 | 6 | 5,41 |
| DC-16 | 1 - 16 | 8 | 6,73 |
| DC-20 | 5 - 20 | 9 | 11,94 |



| DC | | |
|---------|-----------------|-------|
| | Filettatura (A) | € |
| DC -3/8 | 3/8 - 24 UNF | 15,01 |
| DC -1/2 | 1/2 - 20 UNF | 15,01 |



| DC-01 | | | |
|-------|------------|--------------|------|
| | Codolo | Filettatura | € |
| DC-01 | 1/4" Esag. | 3/8 - 24 UNF | 8,68 |

CONI RIDUTTORI
**DIN
2185**



| CR | | | | CR | | | |
|------------|------|----------|-------|------------|------|----------|--------|
| CONO MORSE | | L1 mm | € | CONO MORSE | | L1 mm | € |
| EST. | INT. | | | EST. | INT. | | |
| 1 | 0 | 80 | 17,72 | 5 | 1 | 156 | 62,33 |
| 2 | 1 | 92 | 17,72 | 5 | 2 | 156 | 56,89 |
| 3 | 1 | 99 | 23,83 | 5 | 3 | 156 | 56,89 |
| 3 | 2 | 112 | 24,31 | 5 | 4 | 171 | 61,18 |
| 4 | 1 | 124 | 36,23 | 6 | 3 | 218 | 122,79 |
| 4 | 2 | 124 | 34,03 | 6 | 4 | 218 | 139,32 |
| 4 | 3 | 140 | 34,03 | 6 | 5 | 218 | 139,32 |

CONI AUMENTATORI
**DIN
2187**

| CA | | | | |
|------------|------|----------|----------|--------|
| CONO MORSE | | L1 mm | D1 mm | € |
| EST. | INT. | | | |
| 1 | 2 | 160 | 30 | 39,22 |
| 2 | 3 | 196 | 36 | 53,33 |
| 3 | 4 | 240 | 48 | 89,95 |
| 4 | 5 | 300 | 63 | 150,97 |
| 5 | 6 | 415 | 80 | 445,46 |

CONI RIDUTTORI ESTENSIVI
**DIN
2187**

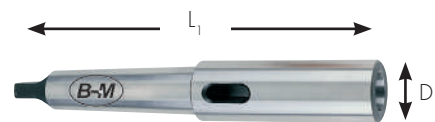

| CA | | | | CA | | | |
|------------|------|----------|--------|------------|------|----------|--------|
| CONO MORSE | | L1 mm | € | CONO MORSE | | L1 mm | € |
| EST. | INT. | | | EST. | INT. | | |
| 2 | 1 | 160 | 26,98 | 5 | 2 | 247 | 127,81 |
| 3 | 1 | 175 | 37,51 | 5 | 3 | 268 | 110,52 |
| 3 | 2 | 194 | 40,50 | 5 | 4 | 300 | 124,93 |
| 4 | 1 | 200 | 56,79 | 6 | 3 | 330 | 270,07 |
| 4 | 2 | 215 | 55,51 | 6 | 4 | 355 | 270,07 |
| 4 | 3 | 240 | 58,09 | 6 | 5 | 390 | 272,04 |
| 5 | 1 | 232 | 140,58 | | | | |

CONI ESTENSIVI

| CA | | | | |
|------------|------|----------|----------|--------|
| CONO MORSE | | L1 mm | D1 mm | € |
| EST. | INT. | | | |
| 1 | 1 | 145 | 20 | 26,98 |
| 2 | 2 | 175 | 30 | 39,22 |
| 3 | 3 | 215 | 36 | 59,40 |
| 4 | 4 | 265 | 48 | 95,80 |
| 5 | 5 | 335 | 63 | 206,71 |
| 6 | 6 | 470 | 85 | 474,42 |

ACCESSORI PER PUNTE E MANDRINI

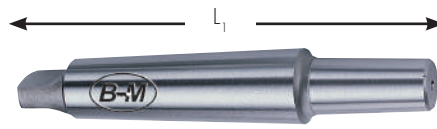
ELEMENTI DI FISSAGGIO CONICI PER MANDRINI



ESTRATTORE PER ELEMENTI DI FISSAGGIO DI MANDRINI CON CONO STANDARDIZZATO B16 E B18



CMEXT
48,16 €

| CM | MANDRINI | L1 mm | € | CM | MANDRINI | L1 mm | € |
|----|----------|-------|-------|----|----------|-------|--------|
| 1 | B10 | 86 | 13,45 | 3 | B22 | 147 | 25,18 |
| 1 | B12 | 89 | 10,11 | 3 | B24 | 157 | 32,42 |
| 1 | B16 | 99 | 10,11 | 4 | B16 | 158 | 22,50 |
| 1 | B18 | 107 | 10,11 | 4 | B18 | 166 | 23,10 |
| 2 | B10 | 105 | 16,08 | 4 | B22 | 176 | 41,53 |
| 2 | B12 | 106 | 11,55 | 4 | B24 | 186 | 42,01 |
| 2 | B16 | 112 | 11,55 | 5 | B16 | 193 | 85,07 |
| 2 | B18 | 119 | 11,55 | 5 | B18 | 200 | 85,07 |
| 2 | B22 | 130 | 21,13 | 5 | B22 | 208 | 85,00 |
| 3 | B12 | 127 | 19,78 | 5 | B24 | 221 | 92,32 |
| 3 | B16 | 134 | 14,97 | 6 | B22 | 240 | 173,61 |
| 3 | B18 | 140 | 14,97 | | | | |

ESTRATTORE CONO MORSE

ELEMENTI DI FISSAGGIO CONICI PER MANDRINI FILETTATI



| N° | VALIDI CM | L1 mm | CE € |
|----|-----------|-------|-------|
| 0 | 0 | 90 | 14,32 |
| 1 | 1 / 2 | 140 | 16,92 |
| 3 | 3 | 190 | 22,35 |
| 4 | 4 | 225 | 30,40 |
| 5 | 5 / 6 | 265 | 49,36 |

| | CM | A | CMR € | CM | A | CMR € | |
|----------|----|---------|-------|----------|---|---------|-------|
| CMR1-3/8 | 1 | 3/8-24h | 21,14 | CMR2-5/8 | 2 | 5/8-16h | 21,14 |
| CMR1-1/2 | 1 | 1/2-20h | 21,14 | CMR3-3/8 | 3 | 3/8-24h | 28,60 |
| CMR2-3/8 | 2 | 3/8-24h | 21,14 | CMR3-1/2 | 3 | 1/2-20h | 28,60 |
| CMR2-1/2 | 2 | 1/2-20h | 21,14 | CMR3-5/8 | 3 | 5/8-16h | 28,60 |

ACCESSORI PER PUNTE

CONTROPUNTE FISSE PER TORNI

CONTROPUNTE ROTANTI PER TORNI



| | D1 mm | L1 mm | CM INT. | CPC € | MD | CPC..MD € |
|-------|-------|-------|---------|--------|----------|-----------|
| CPCM1 | 12 | 80 | 1 | 15,50 | | |
| CPCM2 | 18 | 100 | 2 | 20,63 | CPCM2-MD | 59,30 |
| CPCM3 | 24 | 125 | 3 | 32,06 | CPCM3-MD | 80,94 |
| CPCM4 | 31 | 160 | 4 | 50,07 | CPCM4-MD | 98,72 |
| CPCM5 | 44 | 200 | 5 | 70,76 | CPCM5-MD | 167,82 |
| CPCM6 | 63 | 270 | 6 | 272,83 | | |

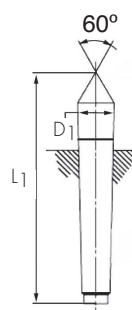

| | D1 mm | D2 mm | L1 mm | CM | PGC € |
|-------|-------|-------|-------|----|--------|
| PGCM1 | 34 | 18 | 120 | 1 | 148,56 |
| PGCM2 | 50 | 21 | 148 | 2 | 165,69 |
| PGCM3 | 60 | 24 | 185 | 3 | 222,75 |
| PGCM4 | 63 | 30 | 220 | 4 | 264,00 |
| PGCM5 | 75 | 44 | 260 | 5 | 381,56 |

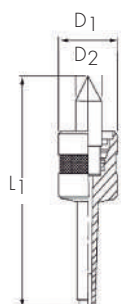

PORTAMASCHI E TESTINE

Ref. TC10

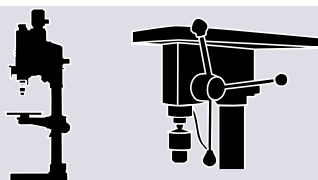
**DIN
228B**

- Con compensazione longitudinale di compressione e trazione.
- Codolo Cono Morse

| | TC10 | | | | | |
|-------------|----------------------|----------------------|----------------------|----------------------|----|--------|
| | D ₁ mm | D ₃ mm | L ₁ mm | L ₂ mm | CM | € |
| TC10-19-CM2 | 36 | 19 | 122 | 47 | 2 | 316,35 |
| TC10-19-CM3 | 36 | 19 | 141 | 47 | 3 | 404,19 |
| TC10-31-CM3 | 53 | 31 | 165 | 71 | 3 | 520,11 |
| TC10-31-CM4 | 53 | 31 | 189 | 72 | 4 | 579,55 |
| TC10-48-CM4 | 78 | 48 | 222 | 105 | 4 | 876,75 |
| TC10-48-CM5 | 78 | 48 | 255 | 106 | 5 | 936,20 |

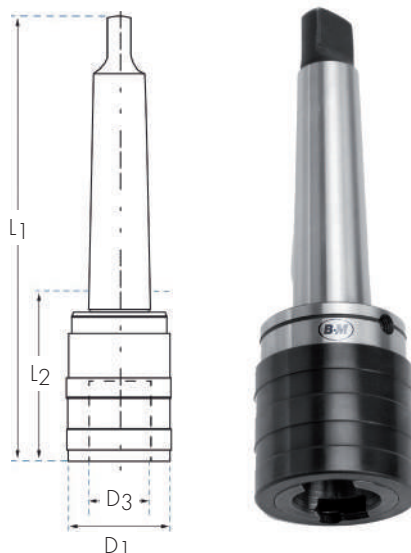
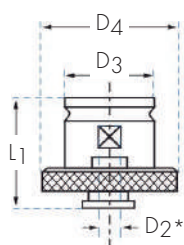
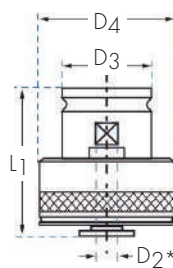
PORTAMASCHI SENZA FRIZIONE

PORTAMASCHI CON FRIZIONE

TC15

| | D ₂ mm | D ₃ mm | L ₁ mm | D ₄ mm | € |
|-------------|----------------------|----------------------|----------------------|----------------------|--------|
| TC15-19-035 | 3,5 | 19 | 28 | 30 | 42,36 |
| TC15-19-040 | 4,0 | 19 | 28 | 30 | 42,36 |
| TC15-19-045 | 4,5 | 19 | 28 | 30 | 42,36 |
| TC15-19-060 | 6,0 | 19 | 28 | 30 | 42,36 |
| TC15-19-070 | 7,0 | 19 | 28 | 30 | 42,36 |
| TC15-19-080 | 8,0 | 19 | 28 | 30 | 42,36 |
| TC15-19-090 | 9,0 | 19 | 28 | 30 | 42,36 |
| TC15-19-100 | 10,0 | 19 | 28 | 30 | 42,36 |
| TC15-31-070 | 7,0 | 31 | 46 | 48 | 59,48 |
| TC15-31-080 | 8,0 | 31 | 46 | 48 | 59,48 |
| TC15-31-090 | 9,0 | 31 | 46 | 48 | 59,48 |
| TC15-31-100 | 10,0 | 31 | 46 | 48 | 59,48 |
| TC15-31-110 | 11,0 | 31 | 46 | 48 | 59,48 |
| TC15-31-120 | 12,0 | 31 | 46 | 48 | 59,48 |
| TC15-31-140 | 14,0 | 31 | 46 | 48 | 59,48 |
| TC15-31-160 | 16,0 | 31 | 46 | 48 | 59,48 |
| TC15-48-110 | 11,0 | 48 | 69 | 70 | 157,58 |
| TC15-48-120 | 12,0 | 48 | 69 | 70 | 157,58 |
| TC15-48-140 | 14,0 | 48 | 69 | 70 | 157,58 |
| TC15-48-160 | 16,0 | 48 | 69 | 70 | 157,58 |
| TC15-48-180 | 18,0 | 48 | 69 | 70 | 157,58 |
| TC15-48-200 | 20,0 | 48 | 69 | 70 | 157,58 |
| TC15-48-220 | 22,0 | 48 | 69 | 70 | 157,58 |
| TC15-48-250 | 25,0 | 48 | 69 | 70 | 157,58 |
| TC15-48-280 | 28,0 | 48 | 69 | 70 | 157,58 |

TC16

| | D ₂ mm | D ₃ mm | L ₁ mm | D ₄ mm | € |
|-------------|----------------------|----------------------|----------------------|----------------------|--------|
| TC16-19-035 | 3,5 | 19 | 46 | 32 | 101,66 |
| TC16-19-040 | 4,0 | 19 | 46 | 32 | 101,66 |
| TC16-19-045 | 4,5 | 19 | 46 | 32 | 101,66 |
| TC16-19-060 | 6,0 | 19 | 46 | 32 | 101,66 |
| TC16-19-070 | 7,0 | 19 | 46 | 32 | 101,66 |
| TC16-19-080 | 8,0 | 19 | 46 | 32 | 101,66 |
| TC16-19-090 | 9,0 | 19 | 46 | 32 | 101,66 |
| TC16-19-100 | 10,0 | 19 | 46 | 32 | 101,66 |
| TC16-31-070 | 7,0 | 31 | 69 | 50 | 128,77 |
| TC16-31-080 | 8,0 | 31 | 69 | 50 | 128,77 |
| TC16-31-090 | 9,0 | 31 | 69 | 50 | 128,77 |
| TC16-31-100 | 10,0 | 31 | 69 | 50 | 128,77 |
| TC16-31-110 | 11,0 | 31 | 69 | 50 | 128,77 |
| TC16-31-120 | 12,0 | 31 | 69 | 50 | 128,77 |
| TC16-31-140 | 14,0 | 31 | 69 | 50 | 128,77 |
| TC16-31-160 | 16,0 | 31 | 69 | 50 | 128,77 |
| TC16-48-110 | 11,0 | 48 | 100 | 70 | 285,10 |
| TC16-48-120 | 12,0 | 48 | 100 | 70 | 285,10 |
| TC16-48-140 | 14,0 | 48 | 100 | 70 | 285,10 |
| TC16-48-160 | 16,0 | 48 | 100 | 70 | 285,10 |
| TC16-48-180 | 18,0 | 48 | 100 | 70 | 285,10 |
| TC16-48-200 | 20,0 | 48 | 100 | 70 | 285,10 |
| TC16-48-220 | 22,0 | 48 | 100 | 70 | 285,10 |
| TC16-48-250 | 25,0 | 48 | 100 | 70 | 285,10 |
| TC16-48-280 | 28,0 | 48 | 100 | 70 | 285,10 |

* D₂: Ø Codolo del maschio* Per informazioni sul Ø codolo del maschio (D₂) consultare la pagina 127.

MASCHI M/MF COMPATIBILI PER PORTAMASCHI CON / SENZA FRIZIONE
D2 mm.

| 3,5 | 4 | 4,5 | 6 | 7 | 8 | 9 | 10 | 11 |
|----------|------------|----------|------------|-----------|-----------|-----------|-----------|-----------|
| M3x0,50R | M3,5x0,60R | M4x0,50R | M4,5x0,50R | M9x1,00D | M8x1,25R | M9x1,25R | M10x1,50R | M13x0,75D |
| M3x0,60R | M3,5x0,75R | M4x0,70R | M4,5x0,75R | M9x1,25D | M11x0,75D | M12x0,75D | | M13x1,00D |
| M5x0,50D | | M4x0,75R | M5x0,50R | M10x0,50D | M11x1,00D | M12x1,00D | | M13x1,25D |
| M5x0,75D | | M4x0,80R | M5x0,75R | M10x0,75D | M11x1,25D | M12x1,25D | | M13x1,50D |
| M5x0,80D | | M6x0,50D | M5x0,80R | M10x1,00D | M11x1,50D | M12x1,50D | | M13x1,75D |
| M5x0,90D | | M6x0,75D | M5x0,90R | M10x1,25D | | M12x1,75D | | M14x0,75D |
| | | M6x1,00D | M5x1,00R | M10x1,50D | | | | M14x1,00D |
| | | | M5,5x0,90R | | | | | M14x1,25D |
| | | | M6x0,50R | | | | | M14x1,50D |
| | | | M6x0,75R | | | | | M14x2,00D |
| | | | M6x1,00R | | | | | |
| | | | M6x1,25R | | | | | |
| | | | M8x0,50D | | | | | |
| | | | M8x0,75D | | | | | |
| | | | M8x1,00D | | | | | |
| | | | M8x1,25D | | | | | |
| | | | M8x1,50D | | | | | |

D2 mm.

| 12 | 14 | 16 | 18 | 20 | 22 | 25 | 28 |
|-----------|-----------|-----------|-----------|-----------|-----------|-----------|-----------|
| M15x1,00D | M18x1,00D | M20x1,00D | M22x1,00D | M27x1,00D | M30x1,00D | M33x1,00D | M34x1,50D |
| M15x1,25D | M18x1,25D | M20x1,25D | M22x1,25D | M27x1,50D | M30x1,50D | M33x1,50D | M34x2,00D |
| M15x1,50D | M18x1,50D | M20x1,50D | M22x1,50D | M27x2,00D | M30x2,00D | M33x2,00D | M35x1,50D |
| M15x2,00D | M18x2,00D | M20x2,00D | M22x2,00D | M27x3,00D | M30x3,00D | M33x3,50D | M35x2,00D |
| M16x1,00D | M18x2,50D | M20x2,50D | M22x2,50D | M28x1,00D | M30x3,50D | | M36x1,50D |
| M16x1,25D | M19x1,00D | M21x1,00D | M23x1,00D | M28x1,50D | M32x1,00D | | M36x2,00D |
| M16x1,50D | M19x1,25D | M21x1,25D | M23x1,50D | M28x2,00D | M32x1,50D | | M36x3,00D |
| M16x2,00D | M19x1,50D | M21x1,50D | M24x1,00D | | M32x2,00D | | M36x4,00D |
| M17x1,00D | M19x2,00D | | M24x1,25D | | | | M38x1,50D |
| M17x1,25D | | | M24x1,50D | | | | M38x2,00D |
| M17x1,50D | | | M24x2,00D | | | | |
| | | | M24x3,00D | | | | |
| | | | M25x1,00D | | | | |
| | | | M25x1,25D | | | | |
| | | | M25x1,50D | | | | |
| | | | M25x2,00D | | | | |
| | | | M26x1,00D | | | | |
| | | | M26x1,50D | | | | |
| | | | M26x2,00D | | | | |

* D2: Codolo del maschio

* La tabella si riferisce a codoli a norma DIN:

* R = Rinforzato = DIN371

* D = Ridotto = DIN374 / DIN376

PINZE DI PRECISIONE
**TIPO
ER**
**DIN
6499-B**
 $\alpha: 8^\circ \beta: 30^\circ$

- Pinze adatte ad utensili a codolo cilindrico liscio.

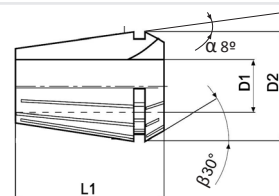
D2: 8,5 L1: 13,5

ER8

| EXC 0,01 | INDUSTRIALE | | EXC 0,005 | ALTA PRECISIONE | |
|-------------|----------------|--------------|--------------|-----------------|---|
| | Capacità D1 | € | | Capacità D1 | € |
| ER8-1 | 0,5-1,0 | 51,97 | ER8-1MICRO | 0,5-1,0 | - |
| ER8-1,5 | 1,0-1,5 | 51,97 | ER8-1,5MICRO | 1,0-1,5 | - |
| ER8-2 | 1,5-2,0 | 44,55 | ER8-2MICRO | 1,5-2,0 | - |
| ER8-2,5 | 2,0-2,5 | 44,55 | ER8-2,5MICRO | 2,0-2,5 | - |
| ER8-3 | 2,5-3,0 | 39,11 | ER8-3MICRO | 2,5-3,0 | - |
| ER8-3,5 | 3,0-3,5 | 39,11 | ER8-3,5MICRO | 3,0-3,5 | - |
| ER8-4 | 3,5-4,0 | 39,11 | ER8-4MICRO | 3,5-4,0 | - |
| ER8-4,5 | 4,0-4,5 | 39,11 | ER8-4,5MICRO | 4,0-4,5 | - |
| ER8-5 | 4,5-5,0 | 39,11 | ER8-5MICRO | 4,5-5,0 | - |

D2: 11,5 L1: 18

ER11

| EXC 0,01 | INDUSTRIALE | | EXC 0,005 | ALTA PRECISIONE | |
|-------------|----------------|--------------|---------------|-----------------|--------------|
| | Capacità D1 | € | | Capacità D1 | € |
| ER11-1 | 0,5-1,0 | 49,50 | ER11-1MICRO | 0,5-1,0 | - |
| ER11-1,5 | 1,0-1,5 | 49,50 | ER11-1,5MICRO | 1,0-1,5 | - |
| ER11-2 | 1,5-2,0 | 42,44 | ER11-2MICRO | 1,5-2,0 | - |
| ER11-2,5 | 2,0-2,5 | 42,44 | ER11-2,5MICRO | 2,0-2,5 | - |
| ER11-3 | 2,5-3,0 | 37,26 | ER11-3MICRO | 2,5-3,0 | - |
| ER11-3,5 | 3,0-3,5 | 37,26 | ER11-3,5MICRO | 3,0-3,5 | 53,33 |
| ER11-4 | 3,5-4,0 | 37,26 | ER11-4MICRO | 3,5-4,0 | 53,33 |
| ER11-4,5 | 4,0-4,5 | 37,26 | ER11-4,5MICRO | 4,0-4,5 | 53,33 |
| ER11-5 | 4,5-5,0 | 37,26 | ER11-5MICRO | 4,5-5,0 | 53,33 |
| ER11-5,5 | 5,0-5,5 | 37,26 | ER11-5,5MICRO | 5,0-5,5 | 53,33 |
| ER11-6 | 5,5-6,0 | 37,26 | ER11-6MICRO | 5,5-6,0 | 53,33 |
| ER11-6,5 | 6,0-6,6 | 37,26 | ER11-6,5MICRO | 6,0-6,6 | 53,33 |
| ER11-7 | 6,5-7,0 | 37,26 | ER11-7MICRO | 6,5-7,0 | 53,33 |

D2: 17 L1: 27,5

ER16

| EXC 0,01 | INDUSTRIALE | | EXC 0,005 | ALTA PRECISIONE | |
|-------------|----------------|--------------|--------------|-----------------|--------------|
| | Capacità D1 | € | | Capacità D1 | € |
| ER16-1 | 0,5-1,0 | 44,36 | ER16-1MICRO | 0,5-1,0 | - |
| ER16-2 | 1,0-2,0 | 39,93 | ER16-2MICRO | 1,0-2,0 | - |
| ER16-3 | 2,0-3,0 | 35,93 | ER16-3MICRO | 2,0-3,0 | - |
| ER16-4 | 3,0-4,0 | 35,93 | ER16-4MICRO | 3,0-4,0 | 47,49 |
| ER16-5 | 4,0-5,0 | 35,93 | ER16-5MICRO | 4,0-5,0 | 47,49 |
| ER16-6 | 5,0-6,0 | 35,93 | ER16-6MICRO | 5,0-6,0 | 47,49 |
| ER16-7 | 6,0-7,0 | 35,93 | ER16-7MICRO | 6,0-7,0 | 47,49 |
| ER16-8 | 7,0-8,0 | 35,93 | ER16-8MICRO | 7,0-8,0 | 47,49 |
| ER16-9 | 8,0-9,0 | 35,93 | ER16-9MICRO | 8,0-9,0 | 47,49 |
| ER16-10 | 9,0-10,0 | 35,93 | ER16-10MICRO | 9,0-10,0 | 47,49 |

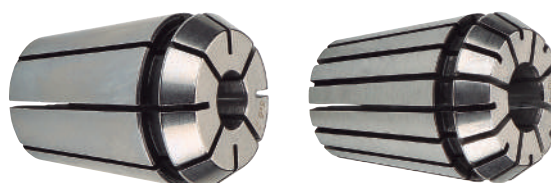
D2: 26 L1: 34

ER25

| EXC 0,01 | INDUSTRIALE | | EXC 0,005 | ALTA PRECISIONE | |
|-------------|----------------|--------------|--------------|-----------------|--------------|
| | Capacità D1 | € | | Capacità D1 | € |
| ER25-2 | 1,0-2,0 | 41,14 | ER25-2MICRO | 1,0-2,0 | - |
| ER25-3 | 2,0-3,0 | 41,14 | ER25-3MICRO | 2,0-3,0 | - |
| ER25-4 | 3,0-4,0 | 41,14 | ER25-4MICRO | 3,0-4,0 | 51,14 |
| ER25-5 | 4,0-5,0 | 41,14 | ER25-5MICRO | 4,0-5,0 | 51,14 |
| ER25-6 | 5,0-6,0 | 41,14 | ER25-6MICRO | 5,0-6,0 | 51,14 |
| ER25-7 | 6,0-7,0 | 41,14 | ER25-7MICRO | 6,0-7,0 | 51,14 |
| ER25-8 | 7,0-8,0 | 41,14 | ER25-8MICRO | 7,0-8,0 | 51,14 |
| ER25-9 | 8,0-9,0 | 41,14 | ER25-9MICRO | 8,0-9,0 | 51,14 |
| ER25-10 | 9,0-10,0 | 41,14 | ER25-10MICRO | 9,0-10,0 | 51,14 |
| ER25-11 | 10,0-11,0 | 41,14 | ER25-11MICRO | 10,0-11,0 | 51,14 |
| ER25-12 | 11,0-12,0 | 41,14 | ER25-12MICRO | 11,0-12,0 | 51,14 |
| ER25-13 | 12,0-13,0 | 41,14 | ER25-13MICRO | 12,0-13,0 | 51,14 |
| ER25-14 | 13,0-14,0 | 41,14 | ER25-14MICRO | 13,0-14,0 | 51,14 |
| ER25-15 | 14,0-15,0 | 41,14 | ER25-15MICRO | 14,0-15,0 | 51,14 |
| ER25-16 | 15,0-16,0 | 41,14 | ER25-16MICRO | 15,0-16,0 | 51,14 |

PINZE DI PRECISIONE

**TIPO
ER**

**DIN
6499-B**

$\alpha: 8^\circ \beta: 30^\circ$

- Pinze adatte ad utensili a codolo cilindrico liscio.

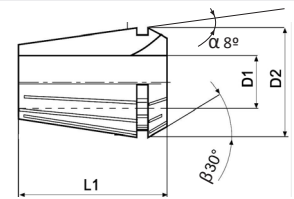

D2: 33 L1: 40

D2: 41 L1: 46

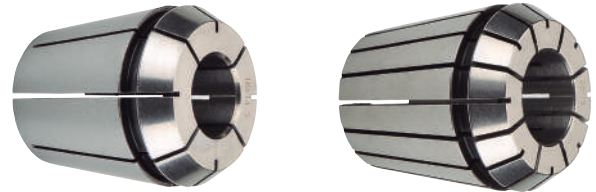
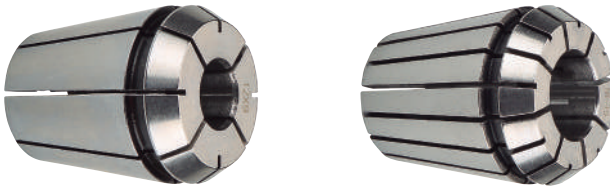

ER32

| EXC 0,01 | INDUSTRIALE | | EXC 0,005 | ALTA PRECISIONE | |
|-------------|----------------|--------------|--------------|-----------------|--------------|
| | Capacità D1 | € | | Capacità D1 | € |
| ER32-3 | 2,0-3,0 | 39,10 | ER32-3MICRO | 2,0-3,0 | - |
| ER32-4 | 3,0-4,0 | 39,10 | ER32-4MICRO | 3,0-4,0 | 53,41 |
| ER32-5 | 4,0-5,0 | 39,10 | ER32-5MICRO | 4,0-5,0 | 53,41 |
| ER32-6 | 5,0-6,0 | 39,10 | ER32-6MICRO | 5,0-6,0 | 53,41 |
| ER32-7 | 6,0-7,0 | 39,10 | ER32-7MICRO | 6,0-7,0 | 53,41 |
| ER32-8 | 7,0-8,0 | 39,10 | ER32-8MICRO | 7,0-8,0 | 53,41 |
| ER32-9 | 8,0-9,0 | 39,10 | ER32-9MICRO | 8,0-9,0 | 53,41 |
| ER32-10 | 9,0-10,0 | 39,10 | ER32-10MICRO | 9,0-10,0 | 53,41 |
| ER32-11 | 10,0-11,0 | 39,10 | ER32-11MICRO | 10,0-11,0 | 53,41 |
| ER32-12 | 11,0-12,0 | 39,10 | ER32-12MICRO | 11,0-12,0 | 53,41 |
| ER32-13 | 12,0-13,0 | 39,10 | ER32-13MICRO | 12,0-13,0 | 53,41 |
| ER32-14 | 13,0-14,0 | 39,10 | ER32-14MICRO | 13,0-14,0 | 53,41 |
| ER32-15 | 14,0-15,0 | 39,10 | ER32-15MICRO | 14,0-15,0 | 53,41 |
| ER32-16 | 15,0-16,0 | 39,10 | ER32-16MICRO | 15,0-16,0 | 53,41 |
| ER32-17 | 16,0-17,0 | 39,10 | ER32-17MICRO | 16,0-17,0 | 53,41 |
| ER32-18 | 17,0-18,0 | 39,10 | ER32-18MICRO | 17,0-18,0 | 53,41 |
| ER32-19 | 18,0-19,0 | 39,10 | ER32-19MICRO | 18,0-19,0 | 53,41 |
| ER32-20 | 19,0-20,0 | 39,10 | ER32-20MICRO | 19,0-20,0 | 53,41 |

ER40

| EXC 0,01 | INDUSTRIALE | | EXC 0,005 | ALTA PRECISIONE | |
|-------------|----------------|--------------|--------------|-----------------|--------------|
| | Capacità D1 | € | | Capacità D1 | € |
| ER40-3 | 2,0-3,0 | 49,69 | ER40-3MICRO | 2,0-3,0 | - |
| ER40-4 | 3,0-4,0 | 49,69 | ER40-4MICRO | 3,0-4,0 | 63,55 |
| ER40-5 | 4,0-5,0 | 49,69 | ER40-5MICRO | 4,0-5,0 | 63,55 |
| ER40-6 | 5,0-6,0 | 49,69 | ER40-6MICRO | 5,0-6,0 | 63,55 |
| ER40-7 | 6,0-7,0 | 49,69 | ER40-7MICRO | 6,0-7,0 | 63,55 |
| ER40-8 | 7,0-8,0 | 49,69 | ER40-8MICRO | 7,0-8,0 | 63,55 |
| ER40-9 | 8,0-9,0 | 49,69 | ER40-9MICRO | 8,0-9,0 | 63,55 |
| ER40-10 | 9,0-10,0 | 49,69 | ER40-10MICRO | 9,0-10,0 | 63,55 |
| ER40-11 | 10,0-11,0 | 49,69 | ER40-11MICRO | 10,0-11,0 | 63,55 |
| ER40-12 | 11,0-12,0 | 49,69 | ER40-12MICRO | 11,0-12,0 | 63,55 |
| ER40-13 | 12,0-13,0 | 49,69 | ER40-13MICRO | 12,0-13,0 | 63,55 |
| ER40-14 | 13,0-14,0 | 49,69 | ER40-14MICRO | 13,0-14,0 | 63,55 |
| ER40-15 | 14,0-15,0 | 49,69 | ER40-15MICRO | 14,0-15,0 | 63,55 |
| ER40-16 | 15,0-16,0 | 49,69 | ER40-16MICRO | 15,0-16,0 | 63,55 |
| ER40-17 | 16,0-17,0 | 49,69 | ER40-17MICRO | 16,0-17,0 | 63,55 |
| ER40-18 | 17,0-18,0 | 49,69 | ER40-18MICRO | 17,0-18,0 | 63,55 |
| ER40-19 | 18,0-19,0 | 49,69 | ER40-19MICRO | 18,0-19,0 | 63,55 |
| ER40-20 | 19,0-20,0 | 49,69 | ER40-20MICRO | 19,0-20,0 | 63,55 |
| ER40-21 | 20,0-21,0 | 49,69 | ER40-21MICRO | 20,0-21,0 | 63,55 |
| ER40-22 | 21,0-22,0 | 49,69 | ER40-22MICRO | 21,0-22,0 | 63,55 |
| ER40-23 | 22,0-23,0 | 49,69 | ER40-23MICRO | 22,0-23,0 | 63,55 |
| ER40-24 | 23,0-24,0 | 49,69 | ER40-24MICRO | 23,0-24,0 | 63,55 |
| ER40-25 | 24,0-25,0 | 49,69 | ER40-25MICRO | 24,0-25,0 | 63,55 |
| ER40-26 | 25,0-26,0 | 49,69 | ER40-26MICRO | 25,0-26,0 | 63,55 |

AFFILATRICE PROFESSIONALE CERTIFICATA BLUE-MASTER

Mandrini e accessori

Rosa



*Include valigetta e mola di scorta



Ref. AFB10

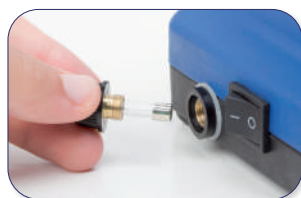

"Dimentica i problemi elettrici delle altre affilatrici"
 Include dispositivo anti-cortocircuiti

AFB10

 CAPACITÀ
 AFFILATURA:

 Ø
3-13

 ANGOLO
 DI TAGLIO:

118°

 TIPI DI
 AFFILATURE:

 RIAFFILA
 PUNTE:

HSS

HSSCo

MD

TiN

PMD

283,04 €
AFFILA PUNTE IN 4 SEMPLICI PASSI:

 1
 Posiziona e regola
 la punta nel mandrino

 2
 Affila la punta

 3
 Controlla l'affilatura convenzionale

 4
 Affilatura secondaria a croce (Split Point)

MANDRINO DI RICAMBIO

 PAFB10
 33,25 €

MOLA IN DIAMANTE GRANA STANDARD

 MAFB10
 34,82 €

SUPPORTO PER AFB10

 SOPAFB10
 31,16 €

AFFILTRICI PER PUNTE DRILL DOCTOR

750X
Alta precisione



| AFB1 | | | | |
|----------------------|----------|-------|----|-----------------|
| CAPACITÀ AFFILATURA: | Ø 2,5-19 | | | |
| ANGOLO DI TAGLIO: | 118° | 135° | | |
| TIPI DI AFFILATURE: | | | | |
| RIAFFILA PUNTE: | HSS | HSSCo | MD | TiN PMD |
| *Include valigetta | | | | 520,19 € |

500X
Affilatura professionale



| AFB2 | | | | |
|----------------------|----------|-------|----|-----------------|
| CAPACITÀ AFFILATURA: | Ø 2,5-13 | | | |
| ANGOLO DI TAGLIO: | 118° | 135° | | |
| TIPI DI AFFILATURE: | | | | |
| RIAFFILA PUNTE: | HSS | HSSCo | MD | TiN PMD |
| | | | | 436,95 € |

XP
Pratico ed economico



| AFB3 | | | | |
|----------------------|----------|-------|----|-----------------|
| CAPACITÀ AFFILATURA: | Ø 2,5-13 | | | |
| ANGOLO DI TAGLIO: | 118° | | | |
| TIPI DI AFFILATURE: | | | | |
| RIAFFILA PUNTE: | HSS | HSSCo | MD | TiN PMD |
| | | | | 210,58 € |

ACCESSORI PER AFFILTRICI
MANDRINI PER AFFILTRICI

Per 750X

AFB1PB
78,71 €



Per punta a sinistra

AFB2PBI
78,74 €

MOLA GRANA GROSSA PER AFFILTRICI 750X, 500X

AFBT
75,33 €

MOLA GRANA STANDARD PER AFFILTRICI 750X, 500X

AFBR
75,33 €

VITI PER AFFILTRICI 750X Y 500X

AFBTLL
8,64 €

SUPPORTO PER AFB10

SOPAFB10
31,16 €